



DE

[Home](#) / [Products](#) / [SUB W-20.39](#)[Characteristics / Sound](#)[Construction](#)

SUB W-20.39

The **SUB W-20.39** is the ideal subwoofer for boosting the bass output of smaller or medium-sized speakers. On the one hand, it is powerful enough to generate driving low-range bass effects in normal rooms and, on the other hand, highly compact. In large rooms or if extremely high bass output is required for longer periods, a second subwoofer of the same type can be added.

If the **SUB W-20.39** is to be used in the vicinity of a TV set, then instead of the W 200 S - 4 OHM, we recommend using the magnetically shielded W 200 SC - 4 OHM. This prevents the TV being distorted by the magnetic scatter field.

In addition, it is also possible to use the 8 ohm

Do you have any questions?

**DE**

8 OHM) if the amplifier used does not allow lower impedance speakers to be connected or if several subwoofers are to be combined.

Not available as a complete kit.

TECHNICAL DATA**COMPONENT PARTS LIST****ADDITIONAL CONTENT**

Rated power	75 W
Maximum power	115 W
Nominal impedance Z	4 Ohm
Übertragungsbereich (-10 dB)	30–x Hz
Mittlerer Schalldruckpegel	85 dB (1 W/1 m)
Gehäuseprinzip	Bassreflex
Net volume	39 l
Außenmaß Höhe	396 mm
Außenmaß Breite	320 mm

Do you have any questions?

**DE**

8 OHM) if the amplifier used does not allow lower impedance speakers to be connected or if several subwoofers are to be combined.

Not available as a complete kit.

TECHNICAL DATA**COMPONENT PARTS LIST****ADDITIONAL CONTENT****Component parts list for 1 box**

Woofer	<u>W 200 S - 4 Ohm</u>	1 pc.
Bass reflex tube	<u>BR 25.50</u> (full length)	1 pc.
Terminal	<u>ST 77</u>	1 pc.
Damping material	Polyester wool	2 bags
Wood screws	3.5 x 25 mm	13 pcs.
Cable	2 x 2.5 mm ²	0.5 m

Do you have any questions?

**DE**

8 OHM) if the amplifier used does not allow lower impedance speakers to be connected or if several subwoofers are to be combined.

Not available as a complete kit.

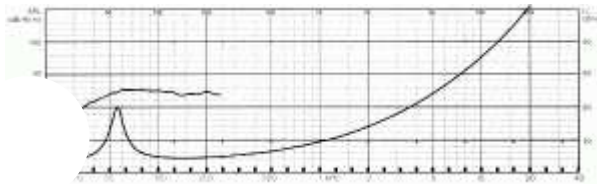
TECHNICAL DATA**COMPONENT PARTS LIST****ADDITIONAL CONTENT****Frequency- and impedance response****Do you have any questions?****Do you have any questions?****Contact us**



DE

[Characteristics / Sound](#)[Construction](#)

SUB W-20.39

Building instruction

Exploded drawing

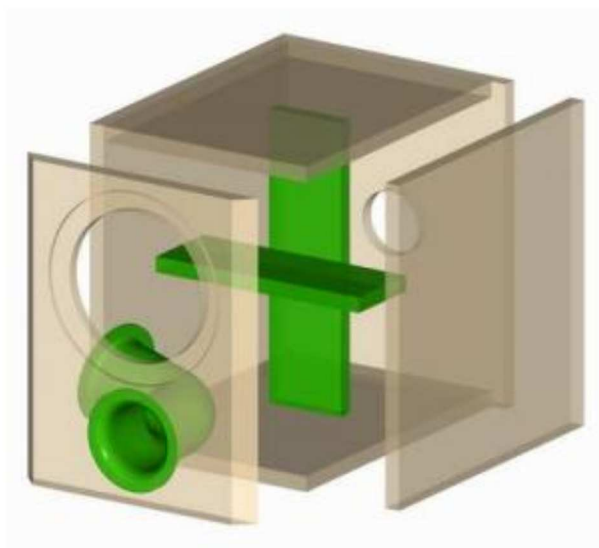

Do you have any questions?

Assembly

Simply glue the boards together (butt-jointed). The chamfers on the baffle can be applied with a power jig or circular saw set to 45° or applied later using an orbital sander.

Next, cut out the openings for the drivers and the bass reflex tube. If an amplifier module is to be used, the cut-out required for fitting it is cut into the rear wall. If no amplifier unit is to be used, fit the **ST 77** connection terminals in the rear wall.



CAPITEL.

DE

Cabinet parts list for 1 box

Parts	Size (mm)	Quantity
Material: 19 mm chipboard or MDF		
Top and bottom panel	282 x 389	2
Side panels	396 x 389	2
Rear panel	396 x 320	1
Brace	358 x 100	1
Brace	282 x 100	1
Material: 22 mm MDF or wood		
Front panel	396 x 320	1

Sketch

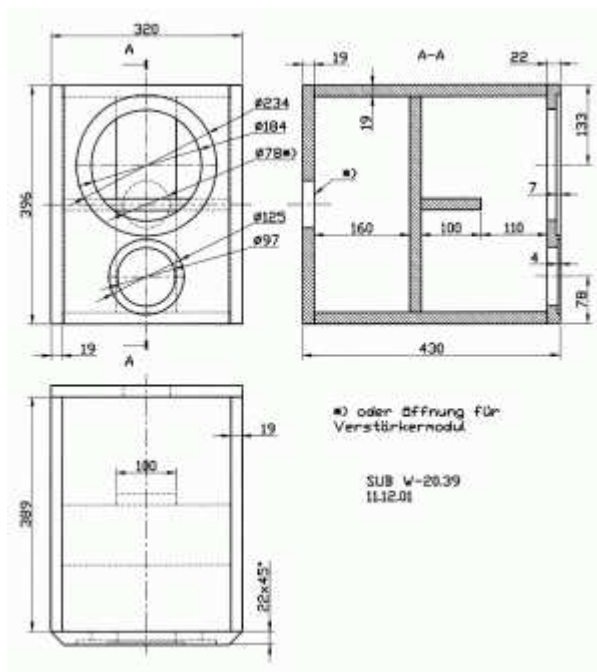

Do you have any questions?