

103 Cowley Close, Maybush, Southampton, Hampshire, SO16 9WE

Asking Price £260,000

Stanford Estate Agents are delighted to present this impressive two bedroom end terrace house offered with no forward chain. This fantastic property boasts a 15ft sitting room/diner, low maintenance garden and a garage. An internal viewing is highly recommended.

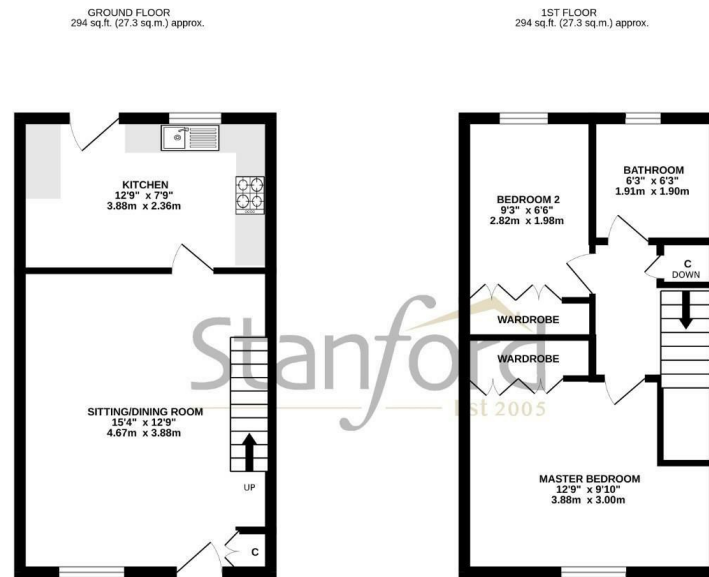

TOTAL FLOOR AREA: 588 sq.ft. (54.6 sq.m.) approx.
 Whilst every attempt has been made to ensure the accuracy of the floorplan contained here, measurements of all items, furniture, fixtures and any other items are approximate and are not intended to be used as such for any prospective purchaser. The number, names and appearance shown here are not meant to be taken as a guarantee of their quantity or efficiency can be given.
 Made with Merge 12024

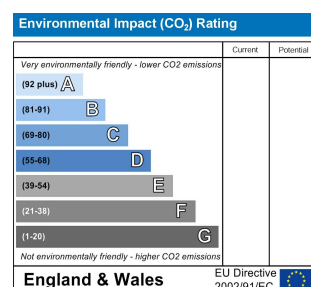
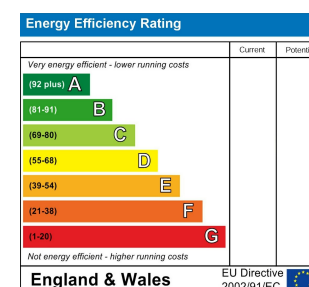

Tel: 023 8202 9966
 Email: bitterne@stanfordestateagents.co.uk
 Address: 394 Bitterne Road, Bitterne, SO18 5RS



While we endeavour to make our sales particulars fair, accurate and reliable, they are only a general guide to the property and, accordingly, if there is any point which is of particular importance to you please contact the office and we will be pleased to check it for you, especially if you are contemplating travelling some distance to view the property. These approximate room sizes are only intended as general guidance. You must verify the dimensions carefully before ordering carpets or any built in furniture. Please note that we have not tested the services or any of the equipment or appliances in this property, accordingly we strongly advise prospective buyers to commission their own survey or service report before finalising their offer to purchase. These particulars are issued in good faith but do not constitute representations of fact or form part of any offer or contract. The matters referred to in these particulars should be independently verified by prospective buyers or tenants. Neither Stanfords nor any of its employees or agents has the authority to make or give any representation or warranty whatever in relation to this property. Your home is at risk if you do not keep up repayments on your mortgage or other loans secured on it. Written quotation are available on

