





# Flat 6, Westridge Court 30 Westridge Road, Portswood, Southampton,

**£950 Per Month**

**Hampshire SO17 2JQ**

Stanford Estate Agents are delighted to present this impressive & spacious one bedroom ground floor maisonette in Portswood. The property is very well presented throughout & boasts double glazing, communal gardens, gated off road parking & is available now. An internal viewing is highly recommended.

## Entrance Hall:

Coved & smooth plaster ceiling, loft hatch, airing cupboard, tiled floor, electric wall mounted heater.

## Lounge/Dining Room: (17'3" x 14'0")

Coved & smooth plaster ceiling, double glazed window to side aspect, double glazed sliding patio door to rear aspect leading out to the communal gardens, electric wall mounted heater, television point, telephone point.

## Kitchen: (7'5" x 6'9")

Smooth plaster ceiling, double glazed window to front aspect, tiling to principle areas, tiled floor, a range of wall mounted & base level units, rolled edge work surfaces, stainless steel sink & drainer with mixer tap above, built in electric hob & electric oven with extractor hood above, space & plumbing for a washing machine, space for a fridge/freezer.

## Bedroom: (17'1" x 9'1")

Coved & smooth plaster ceiling, double glazed window to rear aspect, electric wall mounted heater, television point.

## Bathroom: (6'8" x 6'1")

Smooth plaster ceiling, inset down lighting, extractor fan, fully tiled walls, heated towel rail, panel enclosed bath with shower above, low level WC, wash hand basin.

## Outside:

Well maintained communal gardens which are secluded & mainly laid to lawn. There is also a gated car park providing ample off road parking.

## Other Information:

Local Council: Southampton City Council

Council Tax Band: B

Date Available: Now

Furnishing: Unfurnished

Rent Includes Water

No Pets & No Smokers

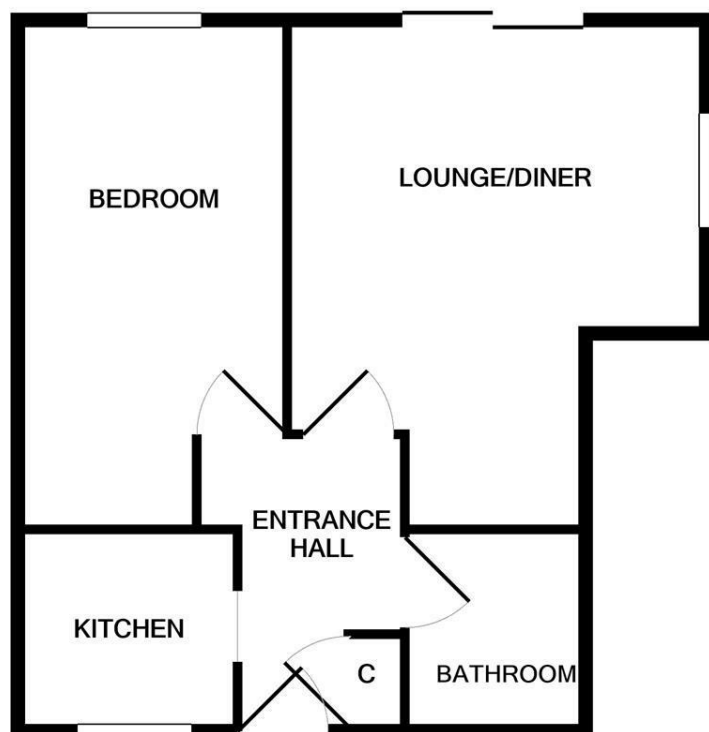

Whilst every attempt has been made to ensure the accuracy of the floor plan contained here, measurements of doors, windows, rooms and any other items are approximate and no responsibility is taken for any error, omission, or mis-statement. This plan is for illustrative purposes only and should be used as such by any prospective purchaser. The services, systems and appliances shown have not been tested and no guarantee as to their operability or efficiency can be given  
Made with Metropix ©2022

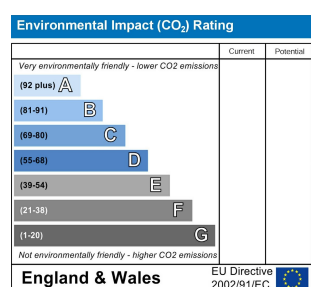
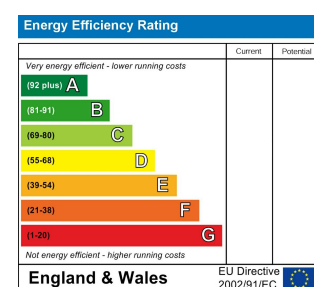

Tel: 023 8064 7272

Email: eastleigh@stanfordestateagents.co.uk

Address: 23High Street, Eastleigh, SO50 5LF



While we endeavour to make our sales particulars fair, accurate and reliable, they are only a general guide to the property and, accordingly, if there is any point which is of particular importance to you please contact the office and we will be pleased to check it for you, especially if you are contemplating travelling some distance to view the property. These approximate room sizes are only intended as general guidance. You must verify the dimensions carefully before ordering carpets or any built in furniture. Please note that we have not tested the services or any of the equipment or appliances in this property, accordingly we strongly advise prospective buyers to commission their own survey or service report before finalising their offer to purchase. These particulars are issued in good faith but do not constitute representations of fact or form part of any offer or contract. The matters referred to in these particulars should be independently verified by prospective buyers or tenants. Neither Stanfords nor any of its employees or agents has the authority to make or give any representation or warranty whatever in relation to this property. Your home is at risk if you do not keep up repayments on your mortgage or other loans secured on it. Written quotation are available on

