



3 Highbury Close, Fair Oak, Eastleigh, SO50 7JG

Asking Price £380,000

Stanford Estate Agents are delighted to offer with no forward chain this extended, three bedroom, detached home located in a small cul-de-sac in Fair Oak. Falling within close proximity to the schools & walking distance to the village amenities this ideally situated property would make a great family home

Starting with a useful entrance porch leading to the entrance hall which has an understairs storage cupboard and leads to the kitchen with large larder. Also off the entrance hall is the lounge/diner spanning over 25ft and has a lovely bay window to the front. The extension incorporates a separate dining room with patio door to the rear garden, separate utility room and a cloakroom with WC facilities, a feature not always found in other local homes. The first floor has three great sized bedrooms all serviced by a modern, fully fitted shower room. A separate WC completes the first floor.

Externally the property sits in a quiet cul-de-sac with a lawn area and parking to the side leading to the garage. The garage has been extended to over 17ft in length and is accessed via an up and over door. The rear garden is an array of lawn, patio, wildflowers and shrub borders and enclosed via panel enclosed fencing and brick wall. The garden is fully private.

Further Information:

- Local Council: Eastleigh Borough Council
- Council Tax Band: D
- Local Primary Schools: Fair Oak Infant & Junior School
- Local Secondary School: Wyvern College
- Sellers Position: No Forward Chain

Local Information:

Fair Oak is a semi rural, small village in the borough of Eastleigh and renowned for its peaceful living offering, Transport links to Winchester, Hedge End and Eastleigh are convenient and an array of amenities are available in the village centre including a chemist, post office facilities and various convenience shops. The local schools are in high demand with the infant, junior and secondary school all achieving 'good' status in their latest OFSTED reports.

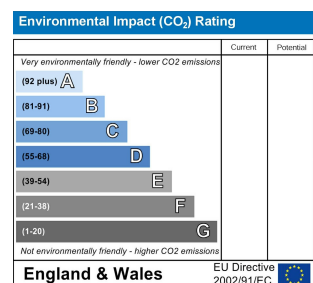
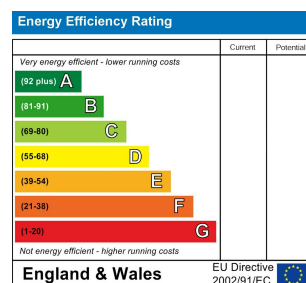
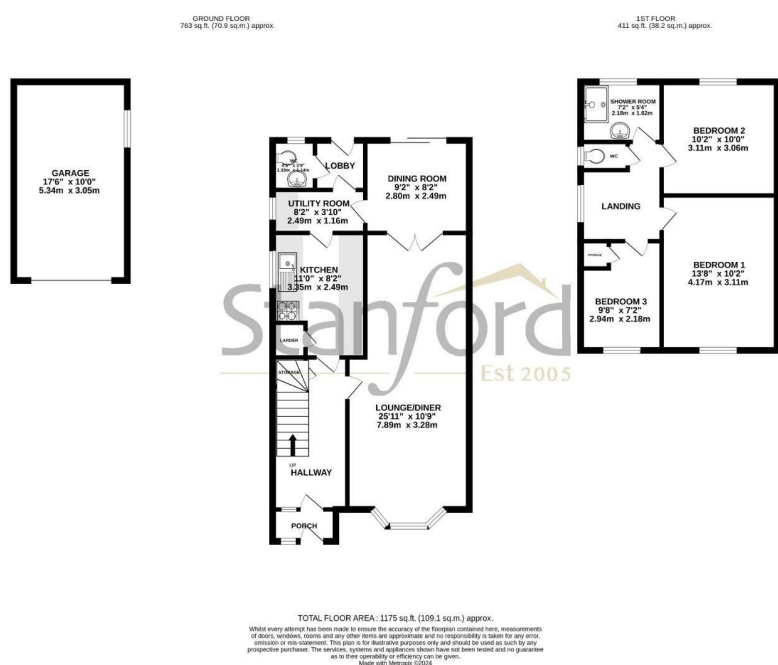

Tel: 023 8064 7272
Email: eastleigh@stanfordestateagents.co.uk
Address: 23High Street, Eastleigh, SO50 5LF



While we endeavour to make our sales particulars fair, accurate and reliable, they are only a general guide to the property and, accordingly, if there is any point which is of particular importance to you please contact the office and we will be pleased to check it for you, especially if you are contemplating travelling some distance to view the property. These approximate room sizes are only intended as general guidance. You must verify the dimensions carefully before ordering carpets or any built in furniture. Please note that we have not tested the services or any of the equipment or appliances in this property, accordingly we strongly advise prospective buyers to commission their own survey or service report before finalising their offer to purchase. These particulars are issued in good faith but do not constitute representations of fact or form part of any offer or contract. The matters referred to in these particulars should be independently verified by prospective buyers or tenants. Neither Stanfords nor any of its employees or agents has the authority to make or give any representation or warranty whatever in relation to this property. Your home is at risk if you do not keep up repayments on your mortgage or other loans secured on it. Written quotation are available on

