



Apartment 11, Hanns Mews Hanns Way, EASTLEIGH, Hampshire, SO50

£995 Per Month

EN17

Stanford Estate Agents are delighted to offer this modern two bedroom apartment in the sought after and convenient location area of central Eastleigh. The property boasts a 21ft sitting room/diner, fully fitted Kitchen, 12ft principal bedroom, stylish bathroom and is walking distance to the Mainline Railway Station and all local amenities. Available NOW!

Sitting Room/Dining Room 21'7 x 11'6

Smooth plaster ceiling, double glazed window to side, radiator, doors leading to kitchen and inner hallway.

Kitchen 8'1 x 6'4

Smooth plaster vaulted ceiling, inset spotlights, Velux window to side, double glazed window to rear, a range of wall and base level units, rolled edge worktops, stainless steel sink and drainer, tiling to principal areas, built in oven and gas hob with extractor hood over, built in fridge and freezer, built in washer dryer.

Inner Hallway

Smooth plaster ceiling and doors leading to all rooms.

Bedroom One 12'5 x 11'6

Smooth plaster ceiling, double glazed window to side, radiator and built in airing cupboard.

Bedroom Two 8'1 x 8'1

Smooth plaster vaulted ceiling, double glazed window to rear and radiator.

Bathroom

Smooth plaster vaulted ceiling, inset spotlights, Velux window to side, double glazed obscure window to rear, fully tiled walls and floors, suite comprising panel enclosed bath with shower over and glass screen, low level WC, wash hand basin, chrome heated towel rail and extractor fan.

Other Information:

Local Council: Eastleigh Borough Council

Council Tax Band: B

Furnishing: Unfurnished

Available: NOW

Tenancy Information:

Holding Fee Tenancy Application -

The tenancy holding deposit is the equivalent of 1 weeks rent which indicates your intentions to proceed with renting the property. Once you have paid your holding fee, we will hold the property for satisfactory references to be sought for an initial period of 15 days from the date of receipt. We are able to extend the period of 15 days agreement deadline by mutual consent in writing should this be required, ie difficulties in obtaining references within the specified time by third parties. Should either you or your guarantors (if applicable) application be unsuccessful because you or any proposed joint tenant(s) change your or their mind(s) and withdraw, fail the rights to rent checks, take the tenancy within a reasonable timescale or fail the referencing process due to the omitting of critical information i.e. adverse credit or misleading information then no monies

will be refunded to you.

Security Deposit -

Before your tenancy commences you will be required to make a security deposit equivalent to one month's rent (This may vary dependent on landlords specific instructions or tenants personal circumstances but will be no more than 5 weeks rent). If the property is managed by Stanford Estate Agents then the deposit will be lodged with the (DPS) If the landlord manages the property they will be responsible for the lodging of any deposit with an appropriate and government accredited custodial scheme.

Late Rent Payment Charges -

A default fee is payable for late payment of rent. This rate is 3% above the Bank Of England's base rate and may only be applied once the rent has been outstanding for a period of 14 days from the rent due date.

Lost Keys/ Entry Devices-

There will be a reasonable charge for the replacement of lost keys or other security devices. In the event of an out of hours call out for the replacement or re-entry of the property, again reasonable charges and costs will be made for this.

Early Termination Of Tenancy -

Should the tenant wish to leave their contract early, they shall be liable to the landlord's costs in re-letting the property as well as all rent due under the tenancy until the start date of the replacement tenancy. These costs will be no more than the maximum amount of rent outstanding on the tenancy.

Tenancy Agreement Changes -

Changes to the tenancy agreement at the tenants request will be charged at no more than £50 inclusive of VAT.

Change Of Share/Tenant -

At the tenants request a charge of £50 inclusive of VAT per replacement tenant or any reasonable costs incurred if higher. To cover the costs associated with taking landlord's instructions, new tenant referencing and Right-to-Rent checks, deposit registration as well as the preparation and execution.

Stanford Estate Agents Ltd are members of The Property Ombudsman Scheme and Client Money Protect - 2024

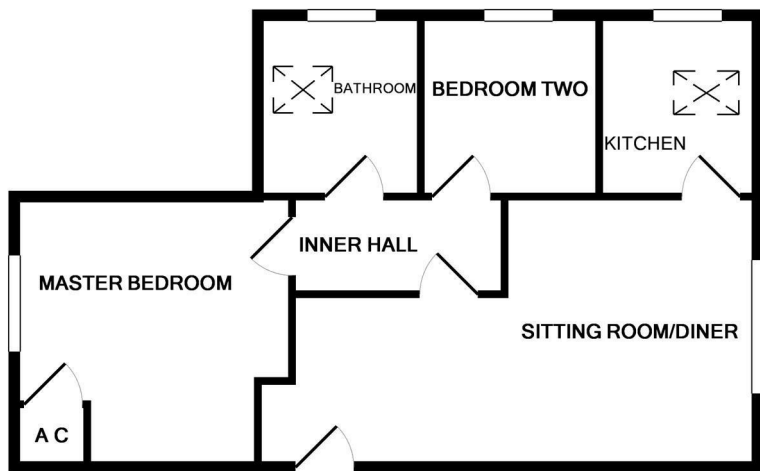

Whilst every attempt has been made to ensure the accuracy of the floor plan contained here, measurements of doors, windows, rooms and any other items are approximate and no responsibility is taken for any error, omission, or mis-statement. This plan is for illustrative purposes only and should be used as such by any prospective purchaser. The services, systems and appliances shown have not been tested and no guarantee as to their operability or efficiency can be given
Made with Metropix ©2016

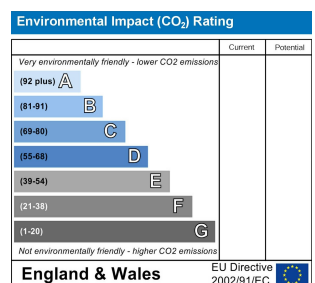
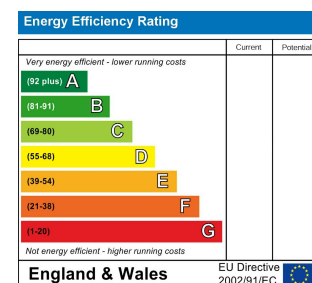

Tel: 023 8064 7272

Email: eastleigh@stanfordestateagents.co.uk

Address: 23High Street, Eastleigh, SO50 5LF



While we endeavour to make our sales particulars fair, accurate and reliable, they are only a general guide to the property and, accordingly, if there is any point which is of particular importance to you please contact the office and we will be pleased to check it for you, especially if you are contemplating travelling some distance to view the property. These approximate room sizes are only intended as general guidance. You must verify the dimensions carefully before ordering carpets or any built in furniture. Please note that we have not tested the services or any of the equipment or appliances in this property, accordingly we strongly advise prospective buyers to commission their own survey or service report before finalising their offer to purchase. These particulars are issued in good faith but do not constitute representations of fact or form part of any offer or contract. The matters referred to in these particulars should be independently verified by prospective buyers or tenants. Neither Stanfords nor any of its employees or agents has the authority to make or give any representation or warranty whatever in relation to this property. Your home is at risk if you do not keep up repayments on your mortgage or other loans secured on it. Written quotation are available on

