

SIZE IN MILLIMETRS

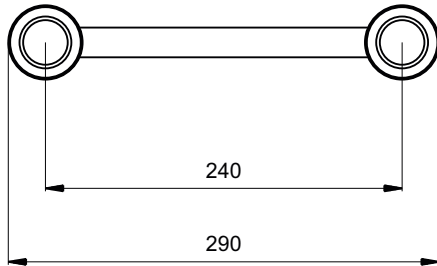

SIZE IN INCHES

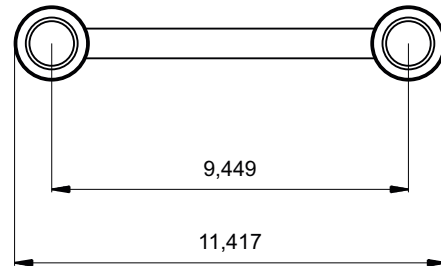

SPECIFICATIONS FT32

TUBES	50x2mm (2 x 0.08inch)
BRACES	20x2mm (0.8 x 0.08inch)
ALLOY	EN-AW 6082 T6



STRAIGHT SEGMENT LENGTHS FT32

CODE	LENGTH		WEIGHT	
FT32-50	0.5m	1.64ft	1.7kg	3.66lbs
FT32-75	0.75m	2.46ft	2.1kg	4.70lbs
FT32-100	1m	3.28ft	2.6kg	5.80lbs
FT32-150	1.5m	4.92ft	3.6kg	8.03lbs
FT32-200	2m	6.56ft	4.6kg	10.23lbs
FT32-250	2.5m	8.20ft	5.7kg	12.46lbs
FT32-300	3m	9.84ft	6.7kg	14.66lbs
FT32-350	3.5m	11.48ft	7.7kg	16.87lbs
FT32-400	4m	13.12ft	8.7kg	19.10lbs
FT32-450	4.5m	14.76ft	9.7kg	21.30lbs
FT32-500	5m	16.40ft	10.7kg	23.53lbs

LOADING TABLES FT32

	2m	4m	6m	8m	10m	12m
Distrib. Load [kg/m]	673	166	76	43	27	18
Deflection [mm]	2.3	9.3	21.9	39.8	63.7	94
Point load [kg]	673	333	228	170	135	110
Deflection [mm]	1.9	7.4	17.6	32.3	52.5	77.7
	6.56ft	13.12ft	19.68ft	26.24ft	32.81ft	37.37ft
Distrib. Load [lb/ft]	452.3	111.6	51.1	28.9	18.1	12.1
Deflection [inch]	0.1	0.4	0.9	1.6	2.5	3.7
Point load [lb]	1484	734.3	502.7	374.9	297.7	242.6
Deflection [inch]	0.1	0.3	0.7	1.3	2.1	3.1

The listed loads are verified for simply supported beam. The truss needs to be secured against horizontal movement every 1m for the loading tables to be valid.