

KTO



THE NARROWEST TRENCH HEATER
WITH A FAN



CHARACTERISTICS

- body made from high quality stainless steel
- high forced convection output
- rapid room heating
- heating also when the fan is off
- low electricity consumption
- safe 12V DC voltage
- contains own microprocessor-controlled unit
- also suitable for heat pump
- electronically commutated (EC) motor

DIMENSIONS

width - with standard frame	109 mm
width - with covering frame	135 mm
height	125 mm
length	900 - 3000 mm
connection *	G3/8"

* external thread on the heat-exchanger, without water connection accessories

CROSS SECTION

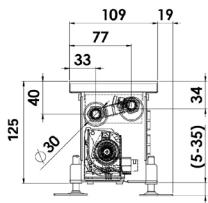

LONGITUDINAL SECTION

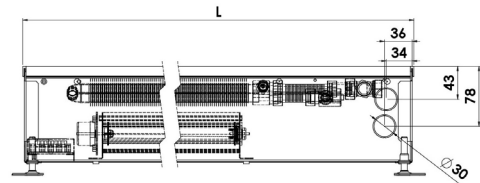
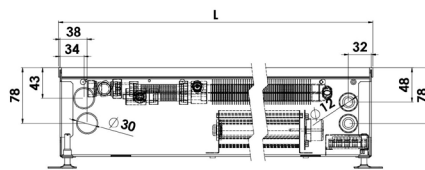

FRAMES

- Standard frame (AL-aluminium)



- Covering frame (AL-aluminium)

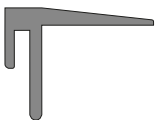

GRILLES - materials



(shades of the grilles are only illustrative)

GRILLES - profile

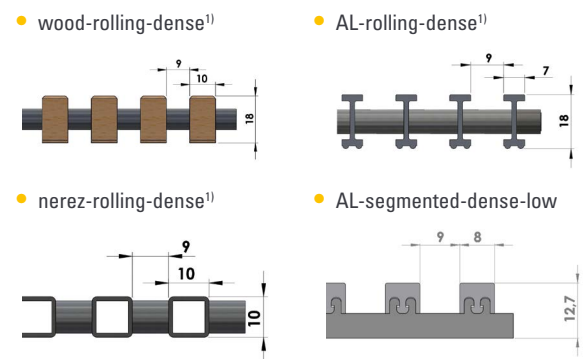

1) the grille must be ordered with the convector due to the modification of the convector construction

Standard grilles are transverse, if you are interested in **LONGITUDINAL GRILLES**, please contact your sales representative.

Convectors are designed to the CONCRETE FLOOR, in case of HOLLOW FLOOR installation, please consult with your sales representative.

The standard delivery includes convector and anchoring accessories. All other accessories (grille, connection accessories, control elements, etc.) must be ordered and specified separately.

As a part of the product development, MINIB, a.s. reserves the right of construction and price adjustments.

ORIENTATION AND CONNECTION OF THE CONVECTOR

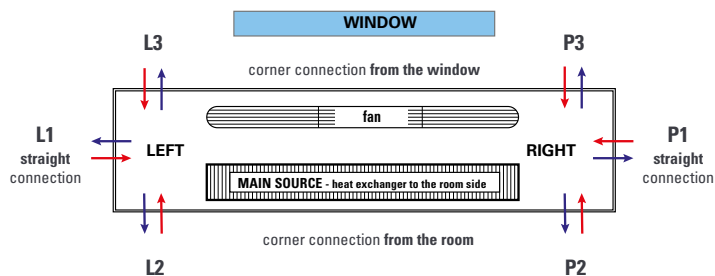

If the convector is used as an **additional heat source** which prevents the condensation of the window (exchanger position at the window side), please consult with your sales representative. Combination of the exchanger position (**room side/window side**), convector type (**left/right**) and water connection (**straight/corner**) must be specified with the order of the convector.

HEATING OUTPUT

length L [mm]	input / output water temperature [°C]	heating output Q [W]			
		speed			
		speed 0	speed 1	speed 2	speed 3
09 = 900	85/75	66	440	517	723
	75/65	55	365	429	600
	65/55	43	290	342	478
	45/40	24	161	190	265
10 = 1000	85/75	77	513	604	844
	75/65	64	426	501	700
	65/55	51	339	399	557
	45/40	28	188	221	309
12 = 1250	85/75	104	697	819	1145
	75/65	86	578	680	950
	65/55	69	460	541	756
	45/40	38	255	300	420
15 = 1500	85/75	131	880	1035	1447
	75/65	109	730	858	1200
	65/55	87	581	683	955
	45/40	48	322	379	530
17 = 1750	85/75	159	1063	1250	1748
	75/65	132	882	1037	1450
	65/55	105	702	825	1154
	45/40	58	390	458	640
20 = 2000	85/75	186	1247	1466	2050
	75/65	154	1034	1216	1701
	65/55	123	823	968	1353
	45/40	68	457	537	751
22 = 2250	85/75	213	1430	1681	2351
	75/65	177	1186	1395	1951
	65/55	141	944	1110	1552
	45/40	78	524	616	861
25 = 2500	85/75	241	1613	1897	2652
	75/65	200	1338	1574	2201
	65/55	159	1065	1252	1751
	45/40	88	591	695	972
27 = 2750	85/75	268	1796	2112	2954
	75/65	223	1491	1753	2451
	65/55	177	1186	1395	1950
	45/40	98	658	774	1082
30 = 3000	85/75	296	1980	2328	3255
	75/65	245	1643	1932	2701
	65/55	195	1307	1537	2149
	45/40	108	725	853	1192

The technical parameters are set according to the relevant standards. In fact, they may vary depending on the location of the convector, the cover grille, the connection type.

CONNECTION OPTIONS AND ACCESSORIES

- connection **WITHOUT HEAD**
- connection **WITH ELECTROTHERMAL HEAD**
- connection **WITH CUSTOMER HEAD** (after consultation)

The type of connection accessories varies according to the type and purpose of the convector. Connection accessories are packed separately and are not included in the standard convector delivery. Information on request from your sales representative or on our website.

REGULATION OPTIONS

Type of regulation	Control	Switched sources
EB-A¹⁾ manual	potentiometer ²⁾	in mounting box: PSB 55W PSB 90W
	potentiometer + thermostat	
	customer thermostat for 24V or 230V + ADA converter	
	BMS superior system	
EB-B automatic	thermostat CH-110	for DIN rail: PSD 55W PSD 90W PSD 115W
	thermostat CH-150	
	customer thermostat for 24V or 230V + ADA converter	
EB-C semi-automatic	thermostat TH 0482	
	customer thermostat for 24V or 230V + ADA converter	

IT IS POSSIBLE TO USE YOUR OWN REGULATION.

- 1) it is necessary to reset the control unit-EB-block (by default it is set to EB-B / EB-C)
- 2) external potential-free switching, e.g. via a boiler

EXAMPLE OF ORDER CODE



Orientation: L = left connection / P = right connection

*orientation and length complete according to the specification of the convector

ACOUSTIC PRESSURE

length L [mm]	Speed		
	speed 1	speed 2	speed 3
	Equivalent acoustic pressure level LAeq,2m [dB]		
900	<20	24,1	34,6
1000	<20	24,4	34,9
1250	<20	25,2	35,7
1500	<20	25,9	36,4
1750	20,4	26,5	37,0
2000	21,0	27,1	37,6
2250	21,5	27,6	38,1
2500	22,0	28,1	38,6
2750	22,5	28,6	39,1
3000	23,0	29,1	39,6

measurement at a distance of 2m from the noise source at 1m height

INPUT POWER

length [mm]	power [W]
900	6
1000	6
1250	10
1500	11
1750	12
2000	16
2250	17
2500	17
2750	22
3000	22

INDIVIDUAL CALCULATION of technical data you can find on our website.

