



Globe Frigo

insulating panel for refrigerated chamber



POLYISOCYANURATE

pueden ser realizados a pedido Available upon request (non / not standard)

ENERGY SAVING IN CONSTRUCTION IS A TOPIC WHICH IS BECOMING MORE AND MORE IMPORTANT. THE SECTOR'S INTEREST IS THEREFORE FOCUSED ON BUILDING PRODUCTS ALREADY MADE WITH COMPONENTS WITH HIGH INSULATION POWER. IS THE SPECIFIC FLAT PANEL FOR MOBILE WALLS, PREFABRICATED BOXES, REFRIGERATING CELLS, EXHIBITION STANDS, SLIDING DOORS, FALSE CEILINGS AND IT IS AN IDEAL COMPONENT FOR PROJECTS WHERE A LIGHT, SOLID AND INSULATING PRODUCT IS REQUIRED. IN ITS "PLANK", "SLATTED", AND "SMOOTH" AND DIAMOND VERSIONS, CONTRIBUTES TO THE DESIGN OF A NEW ARCHITECTURE: CLEAN, SIMPLE AND REGULAR.

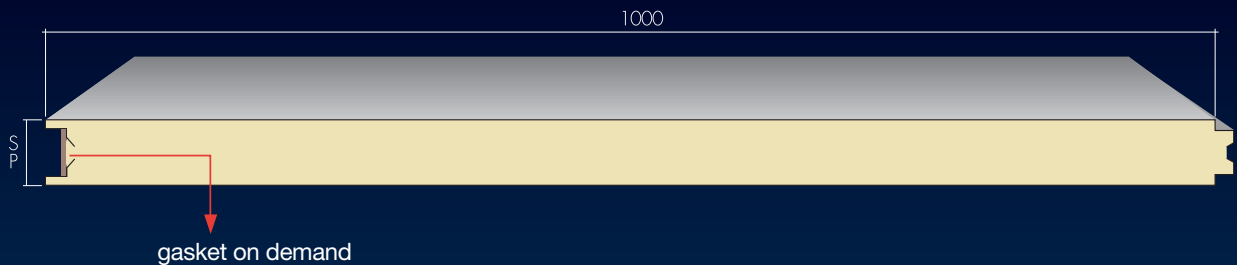

Available facings (to be specified when ordering)



Slatted



Plank

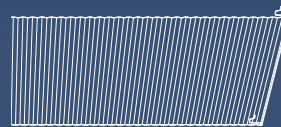

Diamond



Smooth



You can request facings with embossed finish

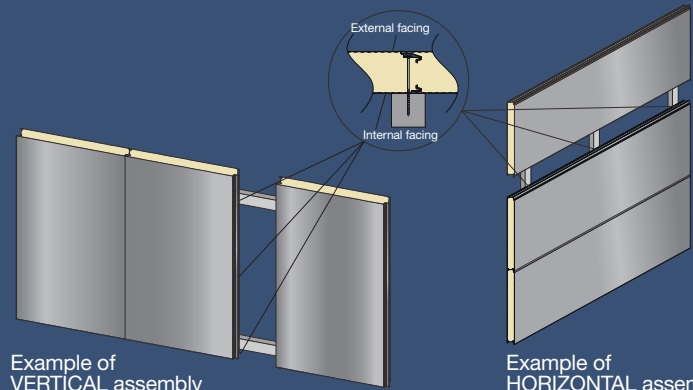

Example of VERTICAL assembly

Example of HORIZONTAL assembly

Standard colours



White grey

Examples of special colours



RAL 1037 Sun yellow



RAL 5011 Steel blue



RAL 8017 Chocolate brown



RAL 9010 White



RAL 9006 Silver grey



Wood colour

All colours shown do not faithfully reproduce the corresponding RAL code.

WALLS polyurethane STAM

Globe Frigo

static characteristics for



Static characteristics (kg/m²)

STATIC
OUTLINE



SINGLE
BAY

External facing: steel 0.4 mm. - Internal facing: steel 0.4 mm.

| PANEL THICKNESS (mm) | DISTANCE BETWEEN SUPPORTS (m) | | | | | | | | | | WEIGHT (Kg/m ²) |
|----------------------|-------------------------------|-----|-----|-----|-----|-----|-----|-----|-----|---|-----------------------------|
| | 1.5 | 2 | 2.5 | 3 | 3.5 | 4 | 4.5 | 5 | 5.5 | 6 | |
| 25 | 165 | 90 | 70 | | | | | | | | 7.02 |
| 30 | 190 | 110 | 85 | 65 | | | | | | | 7.20 |
| 35 | 215 | 125 | 100 | 80 | 55 | | | | | | 7.38 |
| 40 | 236 | 145 | 115 | 90 | 65 | 50 | | | | | 7.56 |
| 50 | 297 | 185 | 150 | 115 | 85 | 65 | 50 | | | | 7.95 |
| 60 | 357 | 225 | 180 | 140 | 105 | 80 | 60 | 50 | | | 8.34 |
| 70 | 370 | 265 | 210 | 165 | 120 | 95 | 75 | 60 | | | 8.73 |
| 80 | 460 | 305 | 245 | 190 | 140 | 105 | 85 | 65 | | | 9.12 |
| 100 | 515 | 385 | 305 | 240 | 175 | 135 | 105 | 85 | | | 9.90 |
| 120 | 620 | 465 | 370 | 290 | 215 | 165 | 130 | 105 | | | 10.68 |
| 150 | 775 | 580 | 465 | 365 | 270 | 205 | 160 | 130 | | | 11.85 |
| 180 | 935 | 700 | 560 | 440 | 325 | 245 | 195 | 155 | | | 13.02 |
| 200 | 1000 | 780 | 625 | 490 | 360 | 275 | 215 | 175 | | | 13.80 |

Calculation for static sizing according to the Annex E of the UNI EN 14509 standard
Deflection limit 1/200 ℓ

Static characteristics (kg/m²)

STATIC
OUTLINE



DOUBLE
BAY

External facing: steel 0.4 mm. - Internal facing: steel 0.4 mm.

| PANEL THICKNESS (mm) | DISTANCE BETWEEN SUPPORTS (m) | | | | | | | | | | WEIGHT (Kg/m ²) |
|----------------------|-------------------------------|-----|-----|-----|-----|-----|-----|-----|-----|-----|-----------------------------|
| | 1.5 | 2 | 2.5 | 3 | 3.5 | 4 | 4.5 | 5 | 5.5 | 6 | |
| 25 | 125 | 75 | 55 | | | | | | | | 7.02 |
| 30 | 151 | 90 | 70 | 60 | 50 | | | | | | 7.20 |
| 35 | 170 | 105 | 85 | 70 | 60 | | | | | | 7.38 |
| 40 | 195 | 125 | 95 | - | 65 | 50 | | | | | 7.56 |
| 50 | 245 | 160 | - | 100 | 80 | 65 | 50 | | | | 7.95 |
| 60 | 295 | 195 | 155 | 125 | 95 | 75 | - | 50 | | | 8.34 |
| 70 | 345 | 230 | 180 | 145 | 110 | 85 | 70 | 55 | | | 8.73 |
| 80 | 395 | 270 | 210 | 165 | 120 | 95 | 75 | 65 | 50 | | 9.12 |
| 100 | 495 | 340 | 265 | 195 | 145 | 115 | 95 | 75 | 65 | 55 | 9.90 |
| 120 | 600 | 415 | 310 | 225 | 170 | 135 | 110 | 90 | 75 | 65 | 10.68 |
| 150 | 735 | 515 | 365 | 270 | 205 | 160 | 130 | 110 | 90 | 80 | 11.85 |
| 180 | 770 | 560 | 415 | 310 | 240 | 190 | 155 | 125 | 105 | 90 | 13.02 |
| 200 | 1000 | 590 | 450 | 335 | 260 | 205 | 170 | 140 | 115 | 100 | 13.80 |

Calculation for static sizing according to the Annex E of the UNI EN 14509 standard
Deflection limit 1/200 ℓ

Static characteristics (kg/m²)

STATIC
OUTLINE



MULTIPLE
BAY

External facing: steel 0.4 mm. - Internal facing: steel 0.4 mm.

| PANEL THICKNESS (mm) | DISTANCE BETWEEN SUPPORTS (m) | | | | | | | | | | WEIGHT (Kg/m ²) |
|----------------------|-------------------------------|-----|-----|-----|-----|-----|-----|-----|-----|-----|-----------------------------|
| | 1.5 | 2 | 2.5 | 3 | 3.5 | 4 | 4.5 | 5 | 5.5 | 6 | |
| 25 | 125 | 75 | 60 | 50 | | | | | | | 7.02 |
| 30 | 151 | 90 | 70 | 60 | 50 | | | | | | 7.20 |
| 35 | 170 | 110 | 85 | 70 | 60 | 50 | | | | | 7.38 |
| 40 | 195 | 125 | 100 | 80 | 70 | 60 | 50 | | | | 7.56 |
| 50 | 245 | 160 | 125 | 105 | 90 | 75 | 60 | 50 | | | 7.95 |
| 60 | 295 | 195 | 155 | 125 | 110 | 85 | 70 | 55 | 50 | | 8.34 |
| 70 | 345 | 230 | 180 | 150 | 120 | 95 | 80 | 65 | 55 | | 8.73 |
| 80 | 395 | 265 | 210 | 170 | 135 | 105 | 85 | 70 | 60 | 50 | 9.12 |
| 100 | 495 | 335 | 265 | 205 | 160 | 125 | 105 | 85 | 75 | 65 | 9.90 |
| 120 | 600 | 410 | 310 | 235 | 180 | 145 | 120 | 100 | 85 | 75 | 10.68 |
| 150 | 735 | 505 | 360 | 275 | 215 | 170 | 140 | 120 | 100 | 90 | 11.85 |
| 180 | 770 | 570 | 410 | 310 | 245 | 200 | 165 | 140 | 120 | 100 | 13.02 |
| 200 | 1000 | 605 | 445 | 335 | 265 | 215 | 180 | 150 | 130 | 110 | 13.80 |

Calculation for static sizing according to the Annex E of the UNI EN 14509 standard
Deflection limit 1/200 ℓ

Thermal characteristics

| U transmittance W/m ² K Kcal/m ² h °C | PANEL NOMINAL THICKNESS (mm) | | | | | | | | | | | | |
|--|--------------------------------|-------|-------|-------|-------|-------|-------|-------|-------|-------|-------|-------|-------|
| | 25 | 30 | 35 | 40 | 50 | 60 | 70 | 80 | 100 | 120 | 150 | 180 | 200 |
| | 0.846 | 0.718 | 0.624 | 0.551 | 0.447 | 0.375 | 0.324 | 0.285 | 0.229 | 0.191 | 0.153 | 0.128 | 0.116 |
| | 0.730 | 0.619 | 0.538 | 0.475 | 0.385 | 0.324 | 0.279 | 0.246 | 0.197 | 0.164 | 0.132 | 0.111 | 0.100 |

Static characteristics (kg/m²)

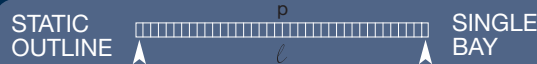

External facing: aluminium 0.6 mm. - Internal facing: steel 0.4 mm.

| PANEL THICKNESS (mm) | DISTANCE BETWEEN SUPPORTS (ml) | | | | | | | | | | WEIGHT (Kg/m ²) |
|------------------------|----------------------------------|-----|-----|-----|-----|-----|-----|-----|-----|---|-----------------------------|
| | 1.5 | 2 | 2.5 | 3 | 3.5 | 4 | 4.5 | 5 | 5.5 | 6 | |
| 25 | 130 | 185 | | | | | | | | | 5.60 |
| 30 | 160 | 120 | 100 | 75 | | | | | | | 5.78 |
| 35 | 185 | 140 | 115 | 85 | 65 | | | | | | 5.96 |
| 40 | 210 | 160 | 130 | 95 | 75 | | | | | | 6.14 |
| 50 | 265 | 200 | 165 | 115 | 90 | 70 | | | | | 6.53 |
| 60 | 315 | 240 | 195 | 140 | 105 | 85 | 70 | | | | 6.92 |
| 70 | 370 | 280 | 225 | 160 | 120 | 95 | 80 | 65 | | | 7.31 |
| 80 | 420 | 320 | 260 | 185 | 140 | 110 | 90 | 75 | | | 7.70 |
| 100 | 530 | 400 | 320 | 225 | 170 | 135 | 110 | 90 | | | 8.48 |
| 120 | 635 | 480 | 385 | 270 | 205 | 160 | 115 | 105 | | | 9.26 |
| 150 | 790 | 595 | 480 | 335 | 250 | 195 | 155 | 130 | | | 10.43 |
| 180 | 950 | 715 | 575 | 405 | 300 | 230 | 185 | 155 | | | 11.60 |
| 200 | 1000 | 780 | 625 | 430 | 315 | 245 | 200 | 170 | | | 12.38 |

Calculation for static sizing according to the Annex E of the UNI EN 14509 standard
Deflection limit 1/200 ℓ

Static characteristics (kg/m²)



External facing: aluminium 0.6 mm. - Internal facing: steel 0.4 mm.

| PANEL THICKNESS (mm) | DISTANCE BETWEEN SUPPORTS (ml) | | | | | | | | | | WEIGHT (Kg/m ²) |
|------------------------|----------------------------------|-----|-----|-----|-----|-----|-----|-----|-----|----|-----------------------------|
| | 1.5 | 2 | 2.5 | 3 | 3.5 | 4 | 4.5 | 5 | 5.5 | 6 | |
| 25 | 115 | 85 | 65 | | | | | | | | 5.60 |
| 30 | 135 | 105 | 75 | | | | | | | | 5.78 |
| 35 | 160 | 120 | 85 | 65 | | | | | | | 5.96 |
| 40 | 185 | 135 | 95 | 70 | | | | | | | 6.14 |
| 50 | 230 | 165 | 110 | 80 | 65 | | | | | | 6.53 |
| 60 | 280 | 190 | 125 | 95 | 75 | | | | | | 6.92 |
| 70 | 330 | 215 | 145 | 105 | 85 | 65 | | | | | 7.31 |
| 80 | 380 | 235 | 160 | 115 | 90 | 70 | | | | | 7.70 |
| 100 | 465 | 280 | 185 | 135 | 105 | 85 | 70 | | | | 8.48 |
| 120 | 530 | 320 | 215 | 155 | 120 | 95 | 80 | 70 | | | 9.26 |
| 150 | 620 | 380 | 255 | 185 | 140 | 115 | 95 | 80 | 70 | | 10.43 |
| 180 | 705 | 440 | 300 | 215 | 165 | 130 | 110 | 90 | 80 | 70 | 11.60 |
| 200 | 745 | 480 | 325 | 235 | 180 | 145 | 115 | 110 | 85 | 75 | 12.38 |

Calculation for static sizing according to the Annex E of the UNI EN 14509 standard
Deflection limit 1/200 ℓ

Static characteristics (kg/m²)

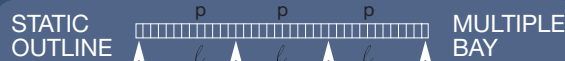

External facing: aluminium 0.6 mm. - Internal facing: steel 0.4 mm.

| PANEL THICKNESS (mm) | DISTANCE BETWEEN SUPPORTS (ml) | | | | | | | | | | WEIGHT (Kg/m ²) |
|------------------------|----------------------------------|-----|-----|-----|-----|-----|-----|-----|-----|----|-----------------------------|
| | 1.5 | 2 | 2.5 | 3 | 3.5 | 4 | 4.5 | 5 | 5.5 | 6 | |
| 25 | 115 | 85 | 65 | | | | | | | | 5.60 |
| 30 | 135 | 105 | 75 | | | | | | | | 5.78 |
| 35 | 160 | 120 | 85 | 65 | | | | | | | 5.96 |
| 40 | 185 | 135 | 95 | 70 | | | | | | | 6.14 |
| 50 | 230 | 165 | 110 | 80 | 65 | | | | | | 6.53 |
| 60 | 280 | 190 | 125 | 95 | 75 | | | | | | 6.92 |
| 70 | 330 | 215 | 145 | 105 | 85 | 65 | | | | | 7.31 |
| 80 | 380 | 235 | 160 | 115 | 90 | 70 | | | | | 7.70 |
| 100 | 465 | 280 | 185 | 135 | 105 | 85 | 70 | | | | 8.48 |
| 120 | 530 | 320 | 215 | 155 | 120 | 95 | 80 | 70 | | | 9.26 |
| 150 | 620 | 380 | 255 | 185 | 140 | 115 | 95 | 80 | 70 | | 10.43 |
| 180 | 705 | 440 | 300 | 215 | 165 | 130 | 110 | 90 | 80 | 70 | 11.60 |
| 200 | 745 | 480 | 325 | 235 | 180 | 145 | 115 | 110 | 85 | 75 | 12.38 |

Calculation for static sizing according to the Annex E of the UNI EN 14509 standard
Deflection limit 1/200 ℓ