

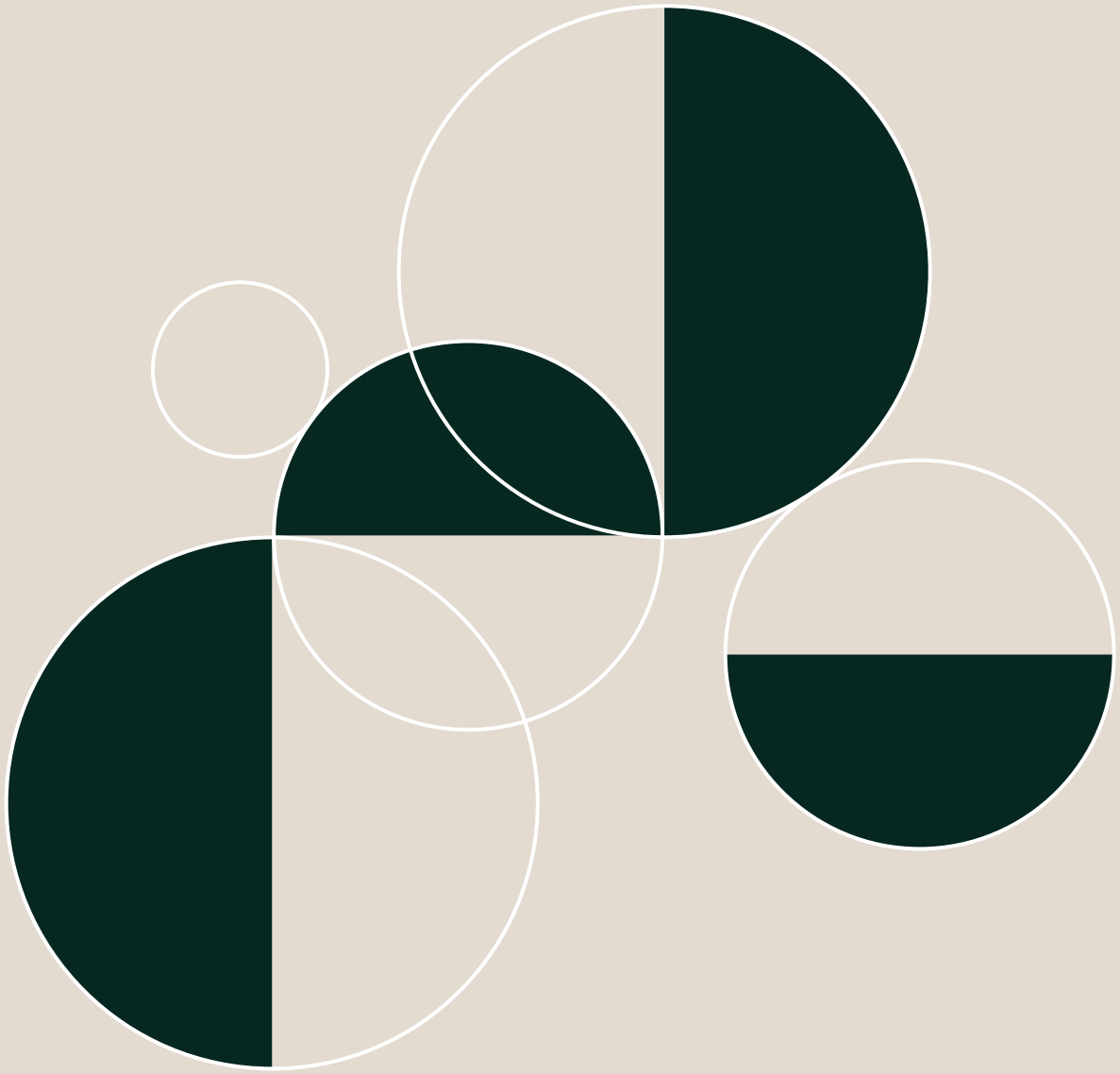

What do you
want to put
in motion?



We want to inspire. To start
something and to carry it forward.
To advise, support, connect and
to captivate. We want to move ...
people and machines. Together at
the Coreum.

What is the Coreum? The Coreum is a one-of-a-kind platform for innovation in Europe – and a unique event location. An open, independent space. Where people can put technology and ideas into motion. To learn and to develop professionally. And to experience hospitality. This is the Coreum. Welcome.

“We need places which are worth visiting. Places which help us take well-founded decisions. Because they offer environments where solutions can be experienced, tested and discussed – and where we can come together to celebrate.”

Dieter Schnittjer, Managing Director of VDBUM



The Coreum attracts individuals from all branches of construction, as well as from material handling and recycling. They come together to work, to learn and to put machines, vehicles, attachments, accessories and services to the test. Hands-on and direct. And they shape the future of their industries.

This unique environment, located just outside Frankfurt am Main in Germany, is a draw for other industries as well – and for trade associations, organisations and individuals. They all use the Coreum's hospitable infrastructure for their own functions. Memorable, exciting events. 365 days a year.

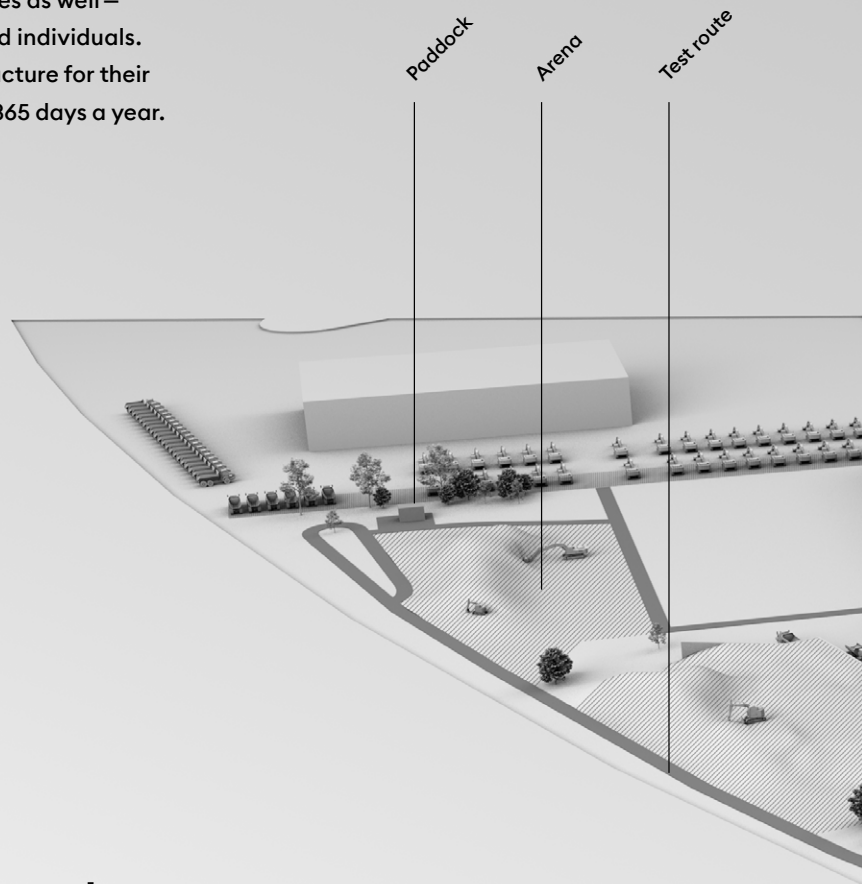

Putting technology and
people into motion on

120,000 m²

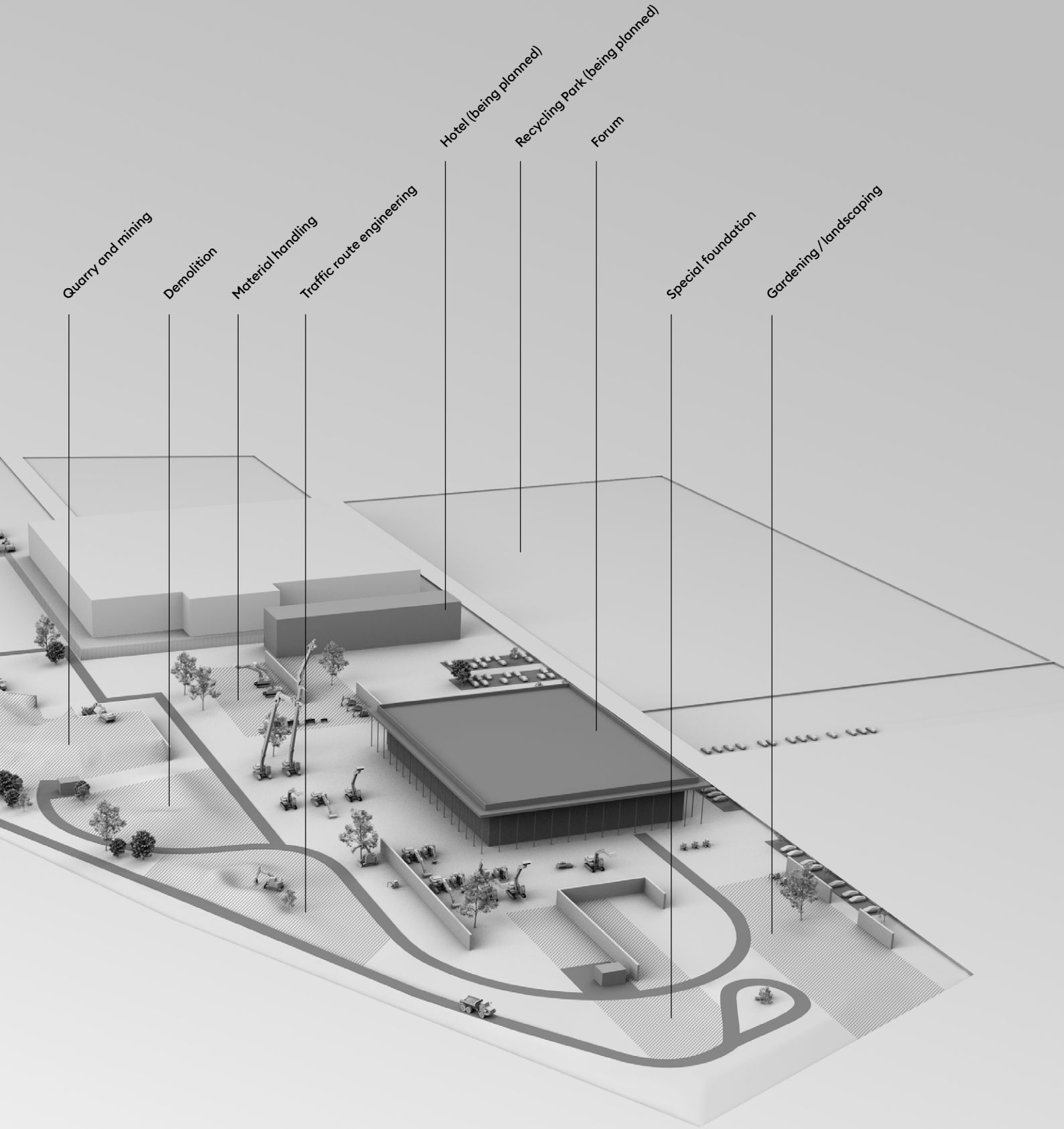

- 13 **explore.** Bauma Park and Exhibition
- 23 **learn.** Workshops and Training
- 33 **experience.** Conferences and Events
- 43 **enjoy.** Restaurant and Catering

Who can
show you
genuine
solutions?

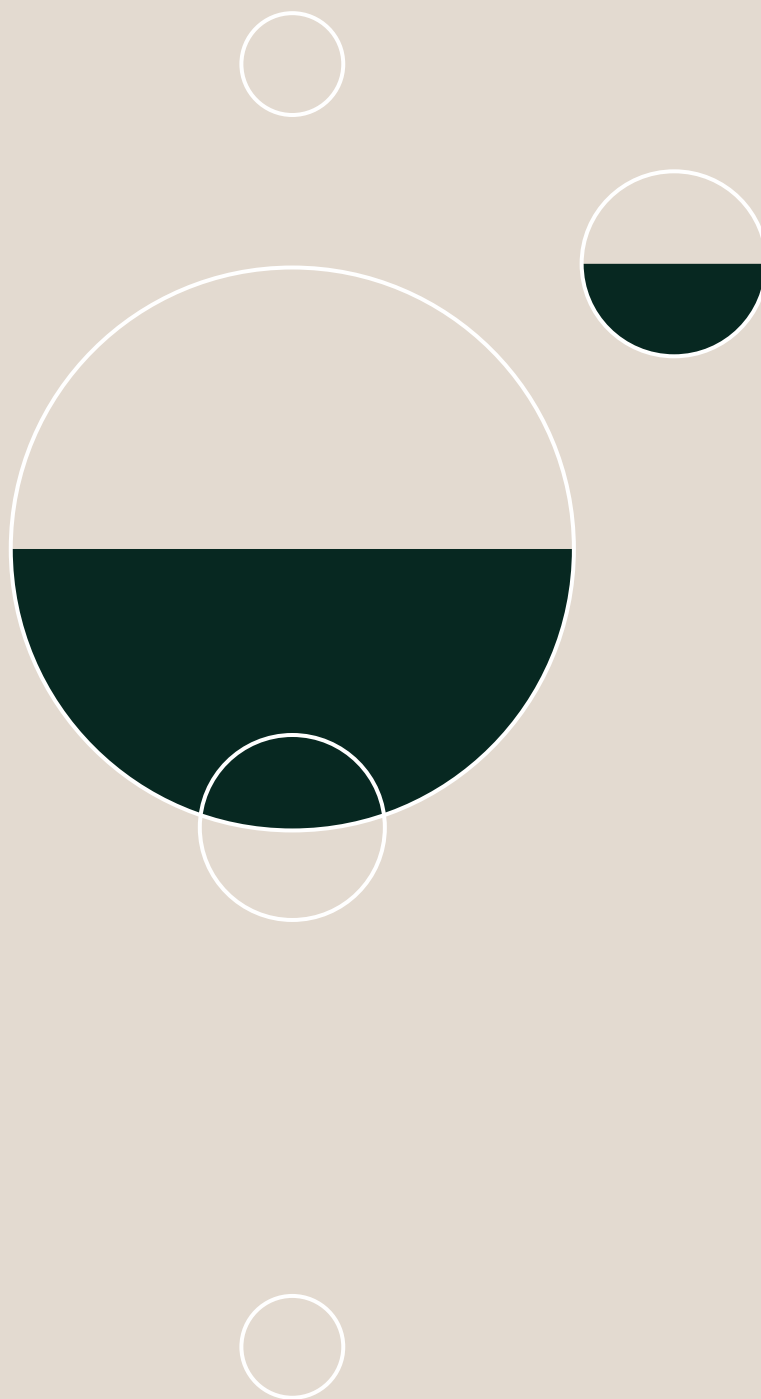

Technology wants to be discovered.

By someone with questions.

Someone who wants to seek out

the answers themselves. To

see things for themselves. To be

astonished. Persuaded. And

to take decisions with their hands

on the wheel.

80,000 m²

Construction, Material Handling and Recycling



Every project requires a unique set of well-harmonised products and services. The Coreum offers an environment where you can experience real solutions in industry-specific contexts. With a brand-agnostic approach. And in combination with one another.

Whether for product comparisons, training, demonstrations or performance testing, the Bauma Park is a place where technology from over 35 premium manufacturers comes to life. Our application consultants select and combine machines, attachments, accessories and services to meet the specific needs of your industry and situation. And, together with you, they put them into motion in real construction situations and on test routes.

Discuss, analyse, and relax: the 5,000-m² Forum is where facts and trends are once again put on the table. In comfort. At lunch in our restaurant. In focus. In one of our meeting or conference rooms. With inspiration. On a tour of our Expo Hall.

Every solution for your project. In one place.
 AFL, Bell, Bohnenkamp, Crown, Demarec,
 Echle Hartstahl, ELA Container, Felasto Pur,
 Fuchs, Geax, Hitachi, HGT, Holp, ifm, IHA,
 Kiebler, Kiesel, Kinshofer, Kleenoil Panolin,
 Ko-Mats, KTEG, Leica Geosystems, LOC-matic,
 Mantsinen, Movax, Oil-Quick, Optimas,
 Protection One, Rädlinger, Rockwheel,
 Tobroco Giant, Tuchel, UAM, Unsinn, VEI.





Gardening / landscaping

Special foundation





Ground engineering and traffic route engineering

“We wanted a place
that makes exploring a
pleasure once again.”

Björn Hickmann, Coreum



Demolition



Material handling

Quarry and mining



rädlinger

2 x 90°-Schwenkbereich
Drehmotor
JR Tilt 90



How do you
combine
theory
and practice?



Feeding the hunger for knowledge.
And addressing the needs of
experienced professionals. With
one-of-a-kind training oppor-
tunities. State-of-the-art equip-
ment. Exchange among equals.
And the finest comfort foods.



COREUM

A photograph showing a worker from behind, wearing a black cap and a high-visibility vest with 'CORR' on the back. The worker is looking towards a large piece of heavy machinery, possibly a wheel loader or excavator, in an outdoor setting.

Operate a boom with precision. Study attachments. Gain maintenance knowledge by the bucketful. In an environment that provides everything you need ... We are experienced practitioners ourselves and have created a space where machine operators can experience the thrill of hands-on training. For unrestricted learning in outdoor areas covering 80,000 m² and in workshops up to 12 metres in height. Where the latest industry-specific machine technology is waiting to be put to use.

Businesses can book our spaces for their own training courses. Or they can sign their operators up for our classes. We also offer customised courses designed to meet specific needs. The goal is always the same: to boost efficiency on the construction site and to prevent costly mishaps and repairs. Demonstrably.

Our popular operator training courses: Material handling, loading machines. Material handling, wheel loaders. Ground engineering, mobile and crawler excavators. Demolition, crawler excavators. Quarry and mining, dump trucks. Quarry and mining, excavators. Quarry and mining, wheel loaders.



“Where else could you run practical training courses for machine operators all year round, independent of the elements? There’s nothing else like it in Germany.”

Jan Hakert, Segment Manager at Leica

400 m³

Indoor sand pit



Dry conditions come rain or shine
— our weatherproof indoor sand
pit is sure to leave an impression —
up to 2.5 metres deep.

Three state-of-the-art workshops with floor spaces ranging from 75 to 175 m² — for technical training, sales training, performance testing and competitor product comparisons. And just a short walk from here, visitors can come together to gain expertise in our fully-equipped seminar rooms.







Where do
you put out
the welcome
mat?

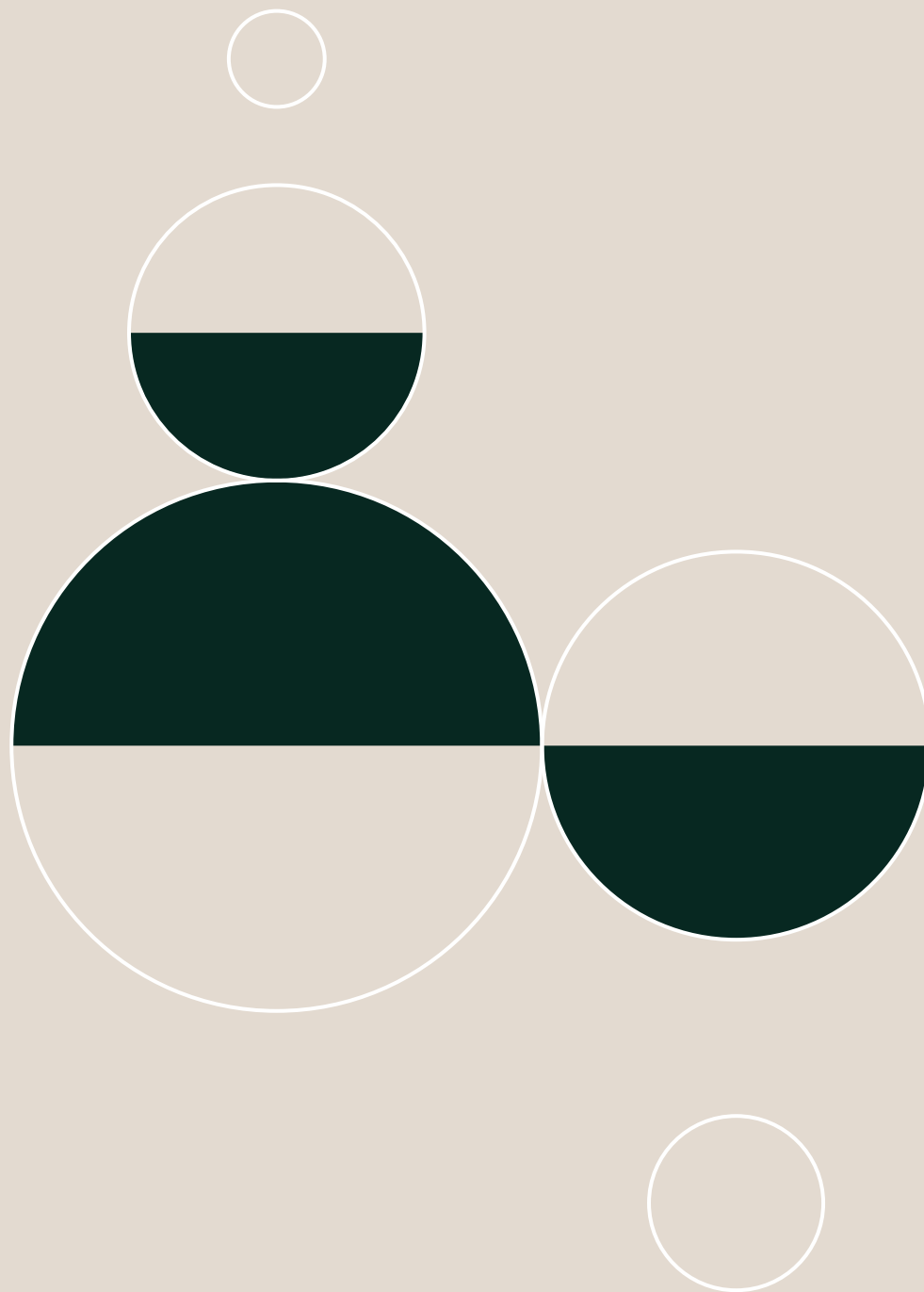

There are those that host events.
And there are those that captivate.
And between them are worlds:
places and spaces. Places that
inspire us. Spaces that welcome us.
That invite us to gather. And
to come together. To experience
something memorable.





**Gala dinners with an industrial flair –
the Expo Hall offers over 850 seats on 1,360 m² of floor space.**



COREUM

Inviting and inspiring. With plenty of concrete. And an abundance of warmth. The Coreum is a state-of-the-art venue. And an impressive location for events of all kinds, from conferences to trade fairs. Product demonstrations and team building events. Celebrations and galas. Concerts and film shoots ... We combine a large selection of spaces with simple logistics. And an understanding of different industries with a passion for event management. We accompany you through your event, from planning to the creation of a varied supporting programme. With professional partners for equipment and catering. To turn any occasion into a memorable experience. For our guests. And their hosts.



12 different event spaces in one location.





Dive on in! The “Freiraum” open space is a place where coaching and workshop participants can relax and think creatively.



Where professionals come together. Conference rooms, seminar rooms and meeting rooms for up to 200 persons.



Meet, discuss, decide. The “Herz” conference room is a meeting space for round tables and other exclusive committees, and offers a view of the Expo Hall.





And where
can
you find
enjoyment?

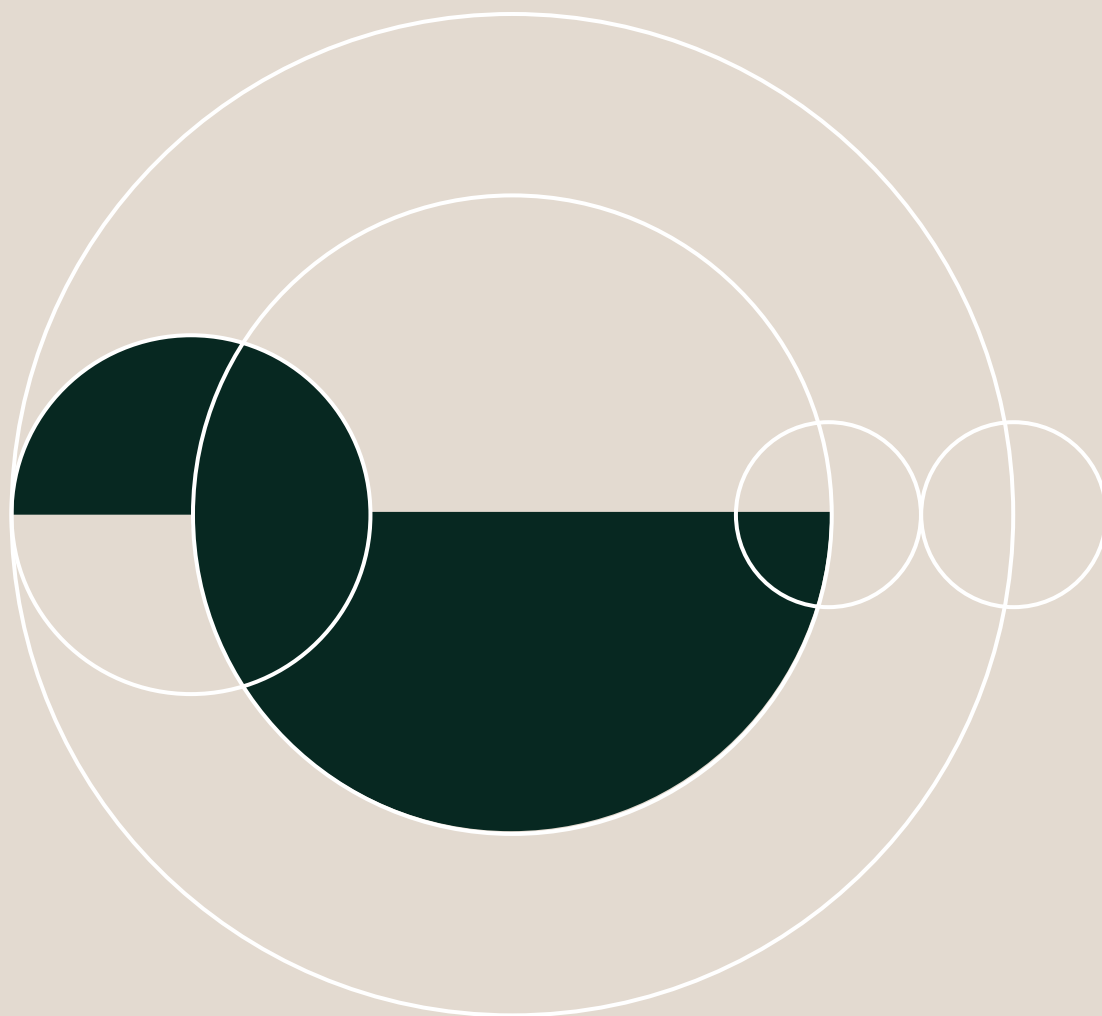

Movers and shakers deserve the
very best food and drink.

To refuel. To take it easy. To stick
around a while and relax. To enjoy.

And to plan your next visit.

With guests from around the world.



Soil and steel. Currywurst and chips? The world of machines can be a rough place. We are raising it to a new level in terms of hospitality and cuisine. With the finest dining, catering and accommodation. After a hard seminar day, Coreum guests can sit back and relax. Between intensive negotiations, they can refuel at the buffet. Enjoy an evening gala free from care. And, from 2021, even stay the night. In our hotel, located just a few metres away. First-rate. Relaxed.



“A modern multipurpose space such as this, with attractive conference and meeting areas and an attached restaurant with good food, is nearly impossible to find in the Rhine-Main region.”

Benjamin Klein, Managing Director of Consortium
Gastronomie GmbH

Outstanding cuisine. Our restaurant not only provides catering for your events. With 130 seats on two floors, it can also be booked for exclusive use.

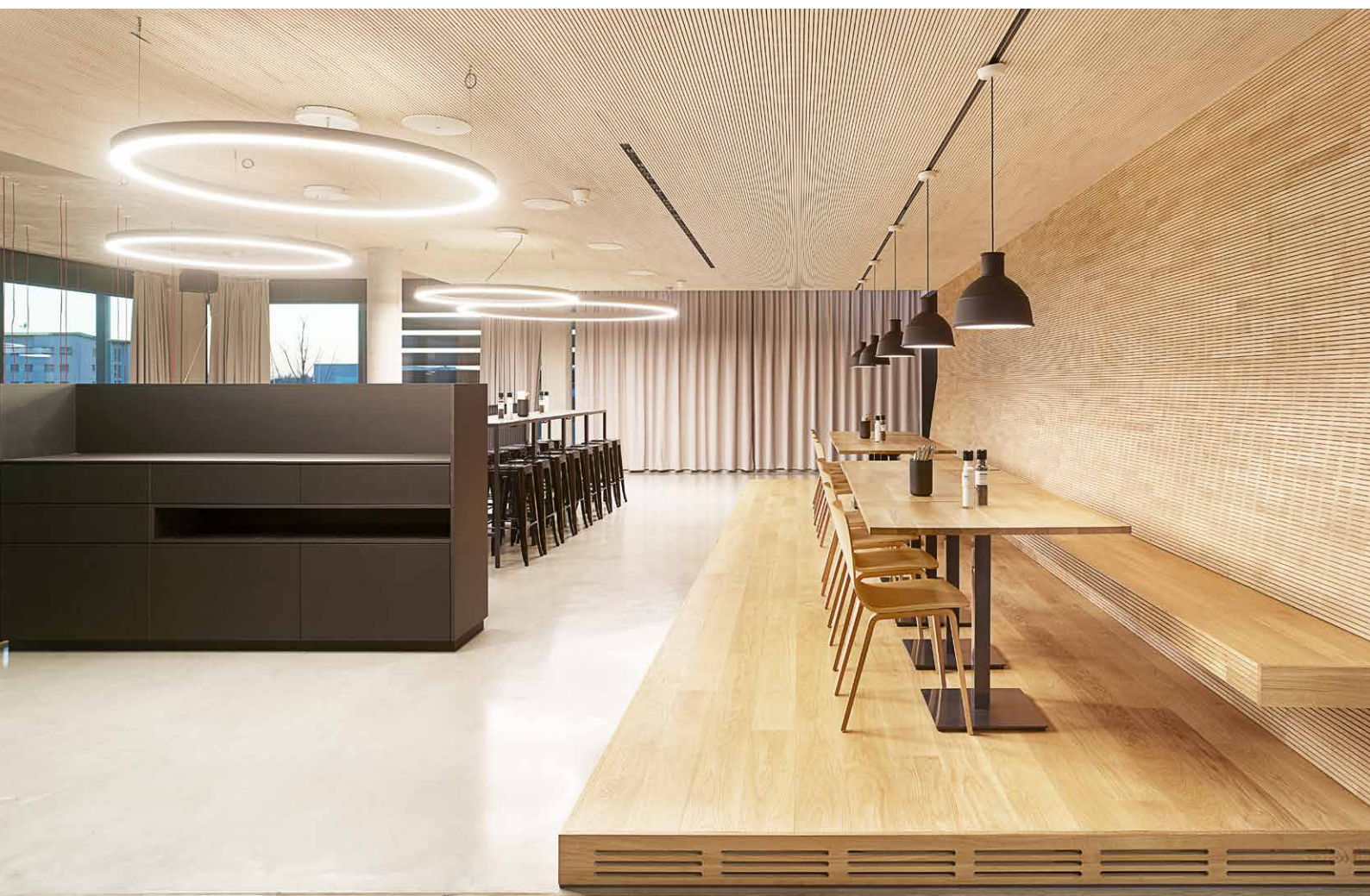





Our in-house food service is dedicated to indulging you and your guests with the finest lunch menus that change every day, as well as exclusive buffets.

**We look
forward
to your visit.**

**Coreum GmbH
Helmut-Kiesel-Str. 2
64589 Stockstadt / Rhein
Germany**

**Plan your visit:
www.coreum.de**

**Questions?
Get in touch with us:
info@coreum.de
Phone: +49 615 860 840**

**Follow us on facebook
and Instagram!**

Machines & Vehicles

HITACHI



BELL

KTEG



KINSHOFER

rädlinger



UAMproline



Attachments

KIESEL



ela[container]



Services & Accessories

