



DISHWASHER

CENTER OF ALL YOUR FOOD SERVICE NEEDS

UNDER COUNTER HIGH TEMPERATURE DISHWASHER WITH DIGITAL CONTROL

Item: 46798

Model: CD-GR-0500



High Performance and Quality Under counter Dishwasher

Features:

- Automatic Fill
- Double skin door
- Automatic drain pump
- Self-cleaning mode
- Built in booster heater
- Built in chemical pumps
- IP 44 washing pump
- Guarantee rinse temperature
- Self-diagnostic mode
- 3 washing programs available
- Easy access for maintenance
- Durable inox construction
- Standard pressure reducer valve (PRV)
- Standard back cover

Product might not be exactly as shown

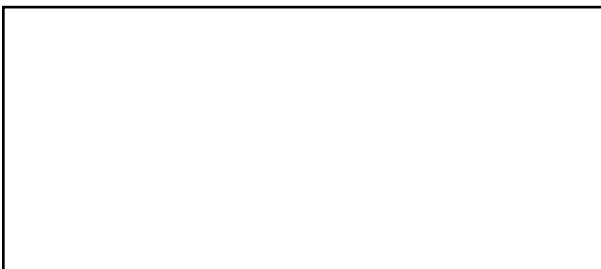

Authorized Dealer



WARRANTY
PARTS AND LABOR



DISHWASHER

UNDER COUNTER DISHWASHER



PRODUCT SPECIFICATIONS

ITEM	46798
MODEL	CD-GR-0500
BASKET SIZE	20" x 20" / 500 x 500 mm
POWER SUPPLY	208-240V / 60Hz / 1 Ph
POWER	3.6 kW
AMP	16 A
WASH PUMP MOTOR	0.75 HP

Plug and Wire (not included): Requires a certified electrician to install unit.

WATER CONNECTION

FLOW PRESSURE	20 psi ± 5
WATER CONSUMPTION / RACK	0.58 gal (2nd program)
WATER CONSUMPTION / HOUR	11.0 gph
WATER INLET CONNECTION	3/4"
DRAINING CONNECTION	1.0"

CAPACITY

CAPACITY	Booster tank: 6L, Wash tank: 35L
HEATING ELEMENT	Booster tank: 3 kW, Wash tank: 2.8 kW
RACK / HOUR (1ST PROGRAM)	28
RACK / HOUR (2ND PROGRAM)	19
RACK / HOUR (3RD PROGRAM)	14
WASH CYCLE 1	103 sec
WASH CYCLE 2	223 sec
WASH CYCLE 3	343 sec
RINSE CYCLE	16 sec

WORKING TEMPERATURE

WASHING	78 °C / 172.4 °F
RINSING	78 °C / 172.4 °F

Commercial dish washer model: CD-GR-0500

- Rinse with fresh water
- Guarantee rinse temperature
- Connection to minimum 55°C water supply

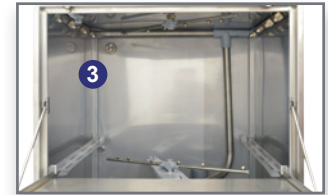

Parts:

1. NSF certified indicators for wash temperature, rinse temperature and rinse pressure
2. 304 stainless steel body and handle, heavy duty & corrosion resistant
3. Upper and lower wash/rinse arms with high temperature cycles
4. 1 peg rack, 1 flat rack & 1 cutlery tray included

DIMENSIONS

DOOR CLEARANCE	14" / 360 mm
USEFUL DOOR OPENING	12.8" / 325 mm
NET DIMENSIONS (WDH)	22.5" x 24" x 33" / 573 x 617 x 836 mm (38" / 966 mm with door open)

GROSS DIMENSIONS

GROSS DIMENSIONS	23" x 27" x 38.5" / 590 x 690 x 980 mm
GROSS WEIGHT	132 lbs/ 60 kg

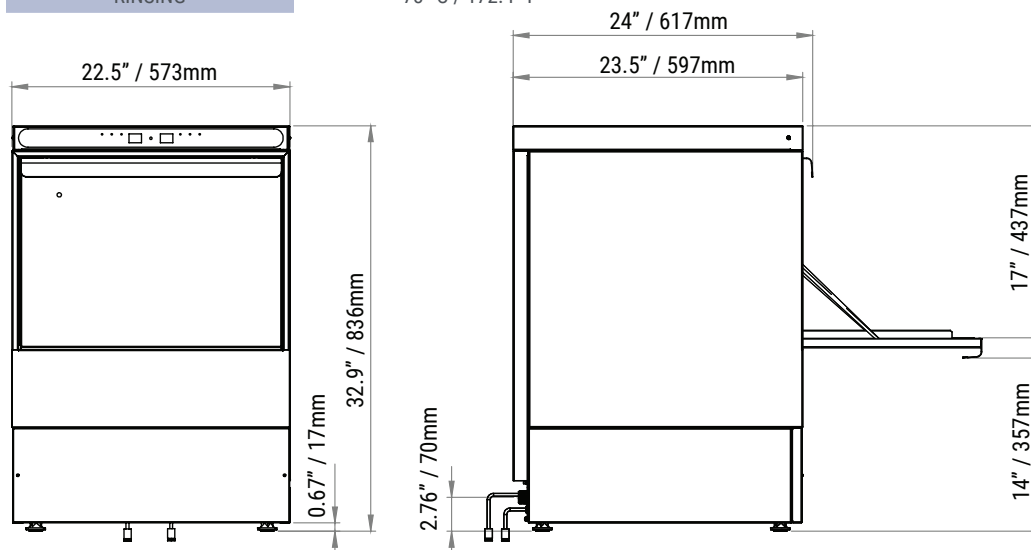

NOTE: Normal operation generates steam that may escape from the door. Materials like wood, laminate etc. are unsuitable for areas exposed to dishwasher steam and only stainless steel surfaces is recommended.

OMCAN INC.

Telephone: 1-800-465-0234
 Fax: (905) 607-0234
 E-mail: sales@omcan.com
 Website: www.omcan.com



Follow us to keep up to date with the latest news and offers

