

REFRIGERATION

36-INCH CURVED GLASS REFRIGERATED DISPLAY
WITH DUAL ACCESS - 7 CU. FT. | RS-CN-0200-F



Item 31866 shown

FEATURES

- Sliding doors in front and back
- #304 Stainless Steel exterior and interior
- Forced air circulation system
- High quality digital temperature controller
- Middle or high back pressure hermetic compressor
- Automatic defrost system
- R134a Gas, Ozone friendly

TECHNICAL SPECIFICATIONS

ITEM NUMBER	31867
MODEL	RS-CN-0200-F
TEMPERATURE RANGE	2°C - 8°C / 35.6°F - 46.4°F
CAPACITY (L / CU. FT.)	200 L / 7 cu. ft.
POWER	0.479 kW
CURRENT	4.84A
REFRIGERANT	R134a, 300g
NUMBER OF SHELVES	2
ELECTRICAL	110V / 60Hz / 1Ph
INTERIOR DIMENSIONS (DWH)	15.75" x 59" x 14.5" 400.05 x 1498.6 x 368.3 mm
DIMENSIONS (DWH)	21.25" x 59" x 31" 539.75 x 1498.6 x 787.4 mm
PACKAGING DIMENSIONS	72" x 36" x 46"/ 1829 x 914 x 1168 mm
PACKAGING WEIGHT	444 lbs./ 201.39 kg.

TECHNICAL DRAWINGS AND DIMENSIONS

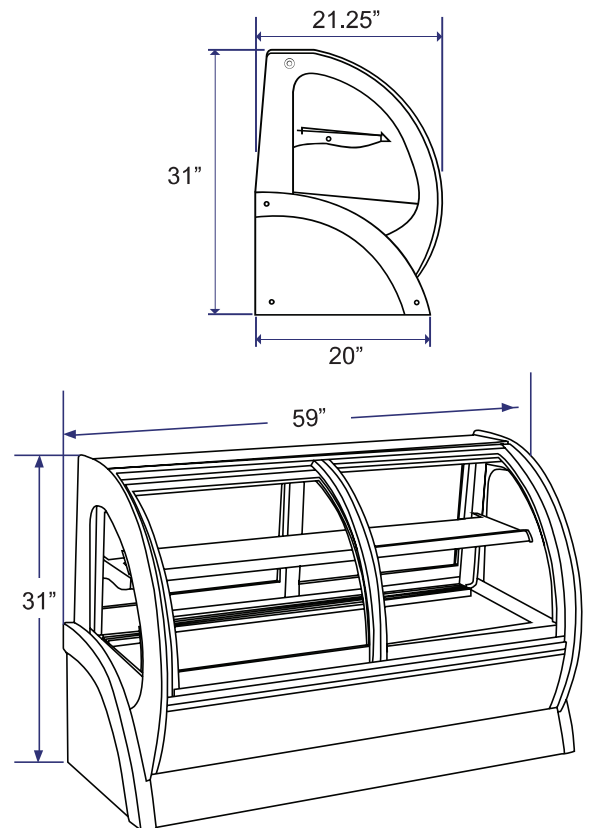

OMCAN INC.

Telephone: 1-800-465-0234

Fax: (905) 607-0234

Email: sales@omcan.com

Website: www.omcan.com



Follow us to keep up to date with the latest news and offers



2016.E.O.E