



REFRIGERATION

SERVING THE FOOD INDUSTRY SINCE 1951

HEAVY DUTY GLASS DOOR BOTTLE COOLERS

Item: 31861 Model: BB-CN-0012-G | Item: 31862 Model: BB-CN-0016-G | Item: 31863 Model: BB-CN-0020-G



KEEP BEVERAGES CHILLED AND READY TO SERVE

Perfect for any restaurant and/or bar, the heavy duty glass door bottle coolers are designed with enduring quality and value. The exterior comprises of heavy-duty wear resistant black coating paint. All stainless steel 304 counter top and stainless steel interior with 304 floor and side. NSF-7 approved for packaged and bottle product and comes with LED lights. Warranty: 1 year parts and labor and 5 years parts only on compressor.



LIMITED WARRANTY
1 YEAR PARTS AND LABOR
5 YEARS PARTS ON COMPRESSOR

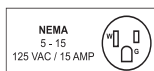

Authorized Dealer

REFRIGERATION

49-INCH HEAVY DUTY GLASS DOOR BOTTLE COOLER



Features:

- Interior--stainless steel 304 floor and side
- Exterior--heavy duty, wear black resistant coating paint
- NSF-7 approved for packaged and bottle product
- Positive seal doors with lock and key
- LED light
- Product capacity: 672 - 12 oz. cans / 2 kegs / 384 - 12 oz. bottles
- Temperature range from 0-5°C / 33-41°F



TECHNICAL SPECIFICATION

ITEM NUMBER	31861
MODEL	BB-CN-0012-G
POWER	0.444 kW
PRODUCT CAPACITY	672 - 12 oz. cans
	2 - kegs
	384 - 12 oz. bottles
NUMBER OF DOORS	2
TEMPERATURE RANGE	33 ~ 41°F / 0 ~ 5°C
CAPACITY	11.8 cu. ft. / 335 L
NUMBER OF SHELVES	4
COMPRESSOR HP	1/3+
ELECTRICAL	115V / 60Hz / 1Ph
AMPS	6.4A
DIMENSIONS (DWH)	24.4" x 48.8" x 36.2" 620 x 1240 x 919 mm
INTERIOR DIMENSIONS (DWH)	20" x 36.2" x 31" 507 x 919 x 787 mm
PACKAGING DIMENSIONS	27.6" x 51.2" x 42.3" 701 x 1300 x 1074 mm
WEIGHT	271 lbs. / 123 kg.
PACKAGING WEIGHT	315 lbs. / 143 kg.

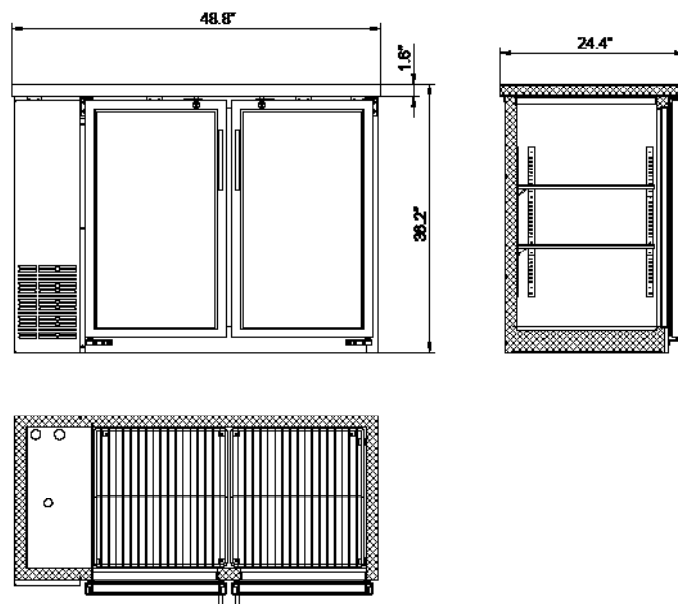

TECHNICAL DRAWING AND DIMENSION

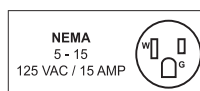

LIMITED WARRANTY
1 YEAR PARTS AND LABOR
5 YEARS PARTS ON COMPRESSOR

OMCAN INC.

Telephone: 1-800-465-0234

Fax: (905) 607-0234

Email: sales@omcan.com

Website: www.omcan.com



Follow us to keep up to date with the latest news and offers



2015.E.O.E

REFRIGERATION

61-INCH HEAVY DUTY GLASS DOOR BOTTLE COOLER



Features:

- Interior--stainless steel 304 floor and side
- Exterior--heavy duty, wear black resistant coating paint
- NSF-7 approved for packaged and bottle product
- Positive seal doors with lock and key
- LED light
- Product capacity: 912 - 12 oz. cans / 2 kegs / 504 - 12 oz. bottles
- Temperature range from 0-5°C / 33-41°F



TECHNICAL SPECIFICATION

ITEM NUMBER	31862
MODEL	BB-CN-0016-G
POWER	0.456 kW
PRODUCT CAPACITY	912 - 12 oz. cans
	2 - kegs
	504 - 12 oz. bottles
NUMBER OF DOORS	2
TEMPERATURE RANGE	33 ~ 41°F / 0 ~ 5°C
CAPACITY	15.8 cu. ft. / 446 L
NUMBER OF SHELVES	4
COMPRESSOR HP	1/3+
ELECTRICAL	115V / 60Hz / 1Ph
AMPS	6.4A
DIMENSIONS (DWH)	24.4" x 60.8" x 36.2" 620 x 1544 x 919 mm
INTERIOR DIMENSIONS (DWH)	20" x 48.2" x 31" 507 x 1224 x 787 mm
PACKAGING DIMENSIONS	27.6" x 63.4" x 42.3" 701 x 1610 x 1074 mm
WEIGHT	326 lbs. / 148 kg.
PACKAGING WEIGHT	380 lbs. / 173 kg.

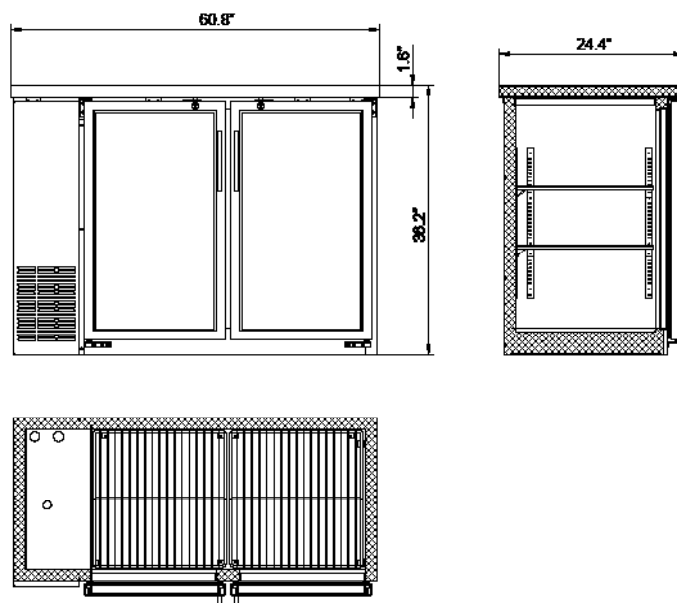

TECHNICAL DRAWING AND DIMENSION

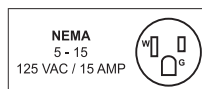

LIMITED WARRANTY
1 YEAR PARTS AND LABOR
5 YEARS PARTS ON COMPRESSOR

OMCAN INC.

Telephone: 1-800-465-0234
Fax: (905) 607-0234
Email: sales@omcan.com
Website: www.omcan.com



Follow us to keep up to date with the latest news and offers



2015.E.O.E

REFRIGERATION

73-INCH HEAVY DUTY GLASS DOOR BOTTLE COOLER



Features:

- Interior--stainless steel 304 floor and side
- Exterior--heavy duty, wear black resistant coating paint
- NSF-7 approved for packaged and bottle product
- Positive seal doors with lock and key
- LED light
- Product capacity: 1152 - 12 oz. cans / 3 kegs / 624 - 12 oz. bottles
- Temperature range from 0-5°C / 33-41°F



TECHNICAL SPECIFICATION

ITEM NUMBER	31863
MODEL	BB-CN-0020-G
POWER	0.504 kW
PRODUCT CAPACITY	1152 - 12 oz. cans 3 - kegs 624 - 12 oz. bottles
NUMBER OF DOORS	3
TEMPERATURE RANGE	33 ~ 41°F / 0 ~ 5°C
CAPACITY	19.6 cu. ft. / 556 L
NUMBER OF SHELVES	6
COMPRESSOR HP	1/3+
ELECTRICAL	115V / 60Hz / 1Ph
AMPS	7.4A
DIMENSIONS (DWH)	24.4" x 72.8" x 36.2" 620 x 1849 x 919 mm
INTERIOR DIMENSIONS (DWH)	20" x 60.2" x 31" 507 x 1528 x 787 mm
PACKAGING DIMENSIONS	27.6" x 75.2" x 42.3" 701 x 1910 x 1074 mm
WEIGHT	355 lbs. / 161 kg.
PACKAGING WEIGHT	410 lbs. / 186 kg.

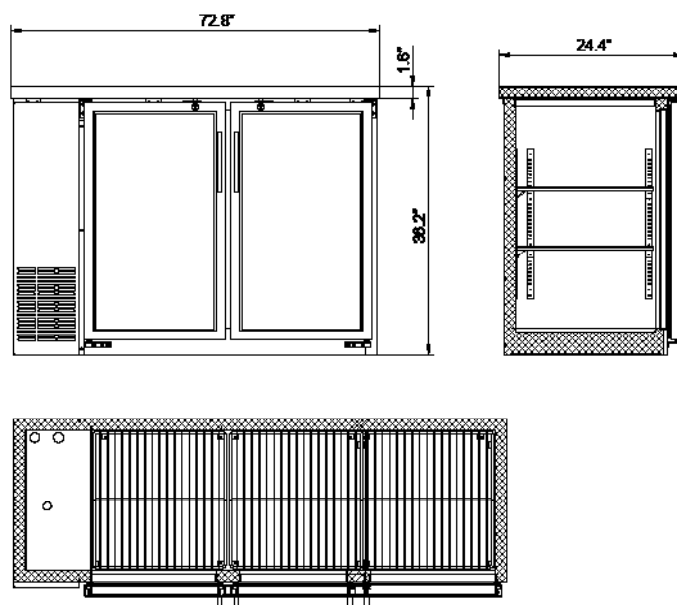

TECHNICAL DRAWING AND DIMENSION

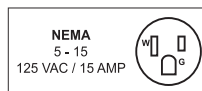

LIMITED WARRANTY
1 YEAR PARTS AND LABOR
5 YEARS PARTS ON COMPRESSOR

OMCAN INC.

Telephone: 1-800-465-0234

Fax: (905) 607-0234

Email: sales@omcan.com

Website: www.omcan.com



Follow us to keep up to date with the latest news and offers



2015.E.O.E