

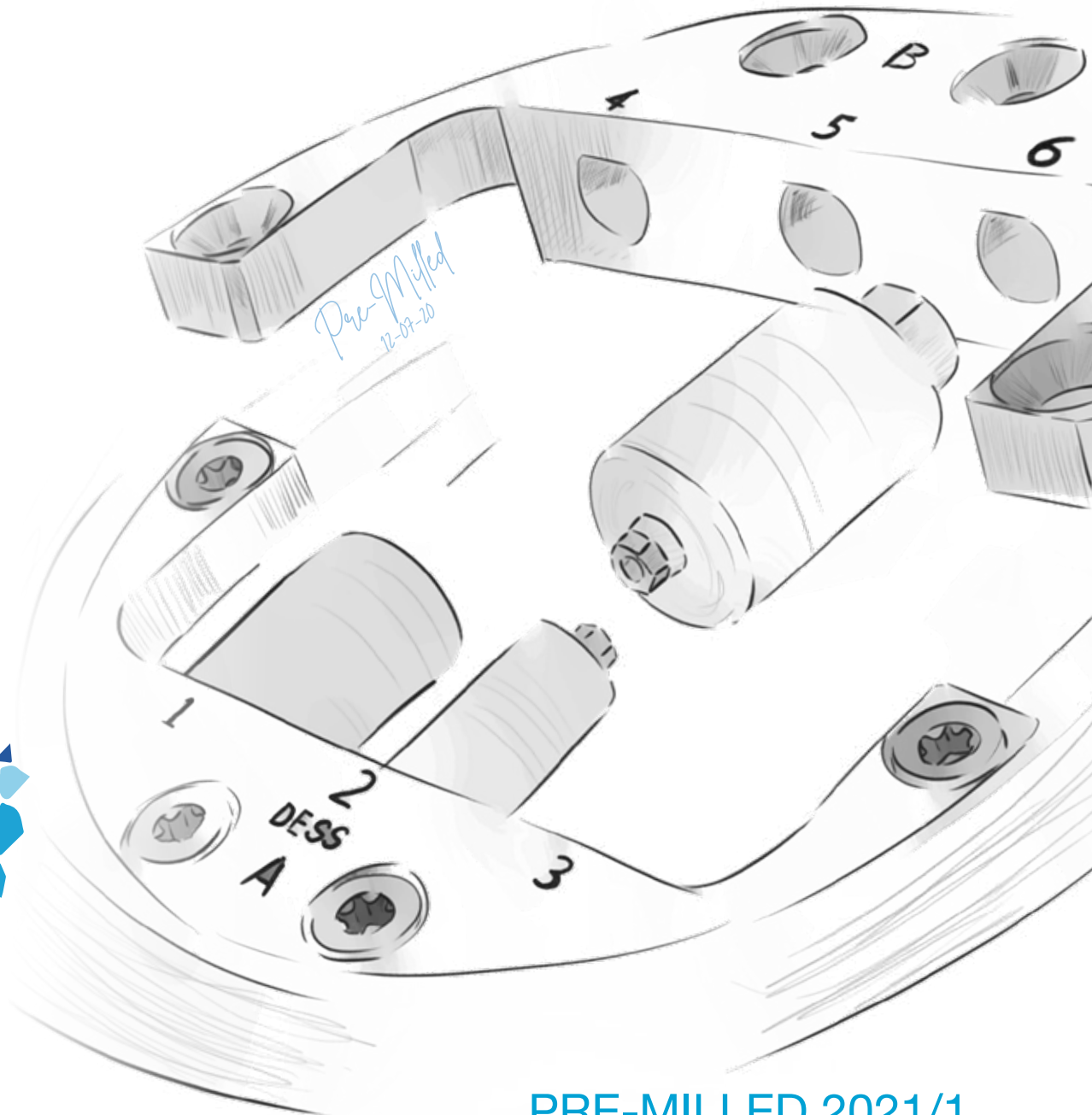

# DESS

> DENTAL SMART SOLUTIONS



PRE-MILLED 2021/1

# PRE-MILLED

Over the last decade, we've seen a revolutionary transformation in the dental industry. New technology added to the rise of saas solutions, are setting the grounds for more customization in the abutments market.

At DESS® we pioneered launching our first range of Pre-milled blanks, back in 2012, but the market wasn't there yet.

In the recent years, however, both in-house milling machines and the CAD/CAM softwares have not only improved but also made the customization more affordable, this in conjunction with a new generation of professionals are helping modern dentistry to thrive and more certainly be at the foreground of the industry.

Now DESS® has become one of the leading manufacturers of premilled and a reference in the DiY dentistry.

DESS® offers a full assortment of Titanium grade V ELI and Cobalt Chrome pre-milled blanks available in 10mm & 14mm diameters, in the most popular implant connections of the market.

The blanks work together with the DESS® holder systems specially developed for Imes-icore® VHF® machines, ZirkonZahn® wet mill, Yenadent® and also available a universal holder for any other machine that use standard 98mm discs and 3R rapid changers.



## The DESS holder system has several advantages to other solutions:

Quick "screw-on" system where the pre-milled blanks are attached to a subholder outside the machine and then placed in the holder that remains in the machine. This makes it easier, cleaner and faster when it comes to placing and removing blocks.

Also, due to the unique way of "pull down and lock" holding system with a screw that secures the pre-milled blank, assuring the maximum precision and stability during the milling process is achieved. Pre-milled socket positions and sub-holders are laser identified to better ensure what is where and optimise the milling process.

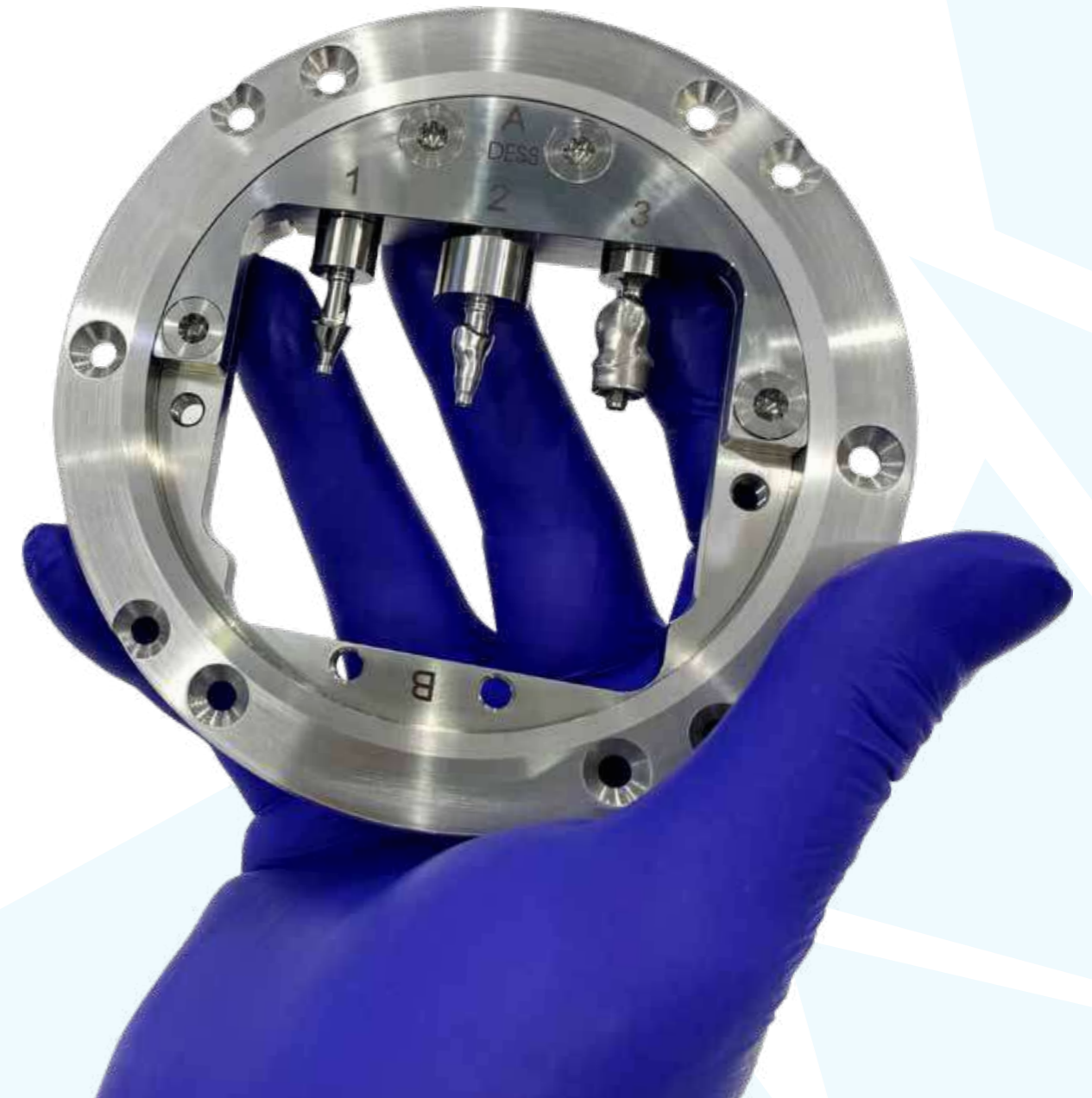



# OUR BLANKS

Only the finest Titanium Grade V ELI (extra low interstitial) or also called Grade 23, and the exclusive Micro Melt Cobalt-Chrome, are used to manufacture our Premilled Blanks.

A total millable length of 20 mm makes it one of the longest in the market.

Our Micro Melt Cobalt-Chrome alloy has no internal tension so however radical your design is, the final custom abutment will preserve the shape along the process resulting in lower probability of ceramic cracks.

The DESS® Cobalt-Chrome is also **Easier to mill** than others alloys in the market, which will preserve your tools.

Contact our support team to know the exact thermal expansion coefficient to assure the highest level of quality on your final work.

Minimal gingival transition height, just 0,3 mm to allow a maximum degree of design freedom.

“Pull down and lock” holding system. Developed by DESS® back in 2012, allows a strong and precise positioning of the pre-milled blank inside its socket.

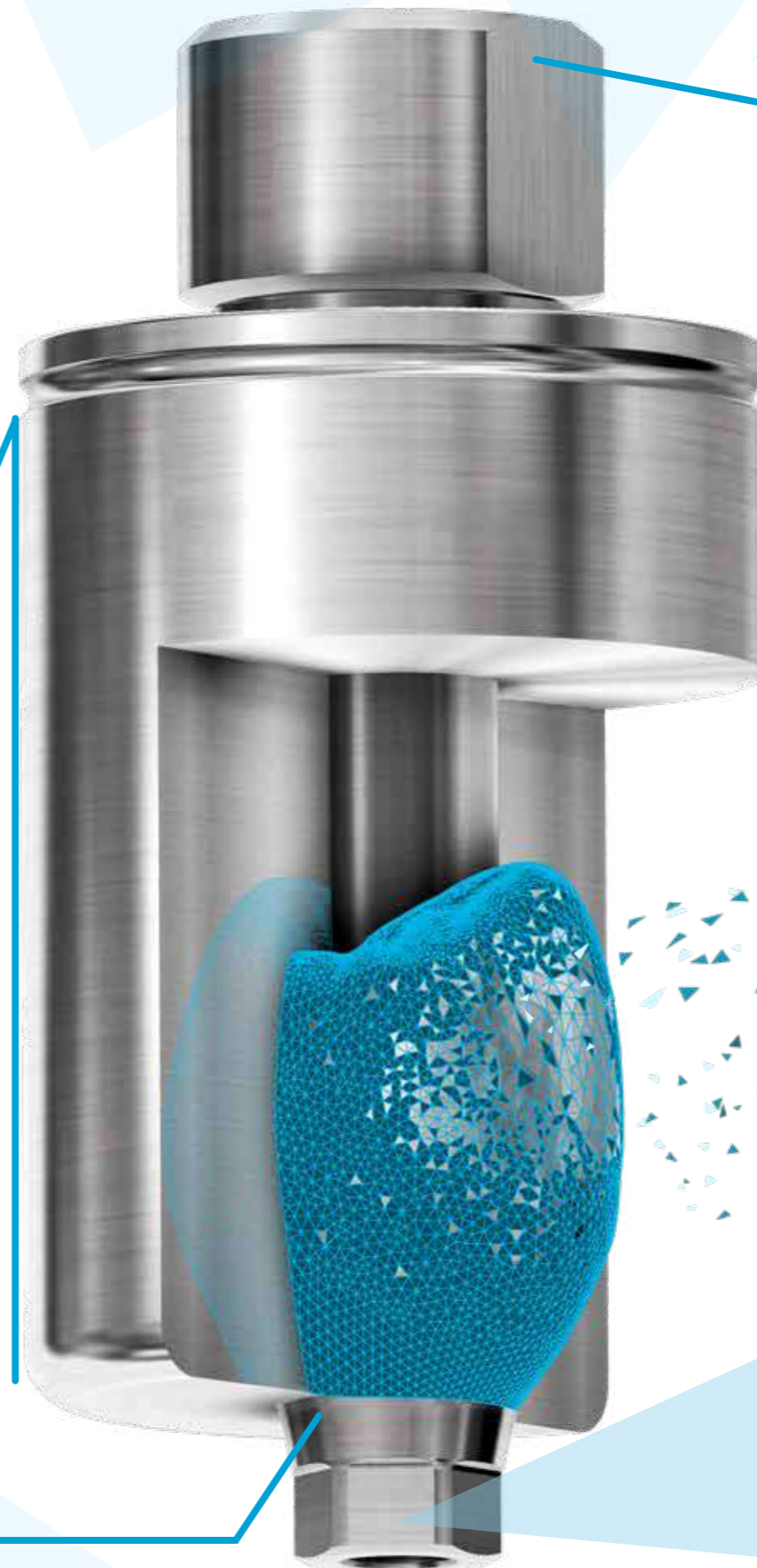

## Available in:

- Titanium 10mm or 14mm
- Cobalt-Chrome 14mm

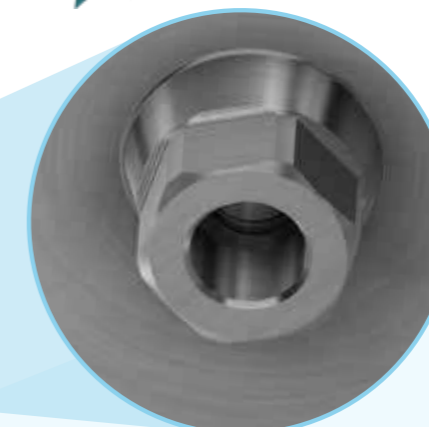

DESS® connection precision is guaranteed in all our Premilled Blanks.

# FULL DIY CONTROL

The DESS® AURUM Milling tool will allow you to create screw retained bars, bridges or multiple with an angulated channel of up to 25° by using the AURUMBase® screw.

This solution is available for those compatibilities where the AURUMBase®, angulated screw channel solution is available

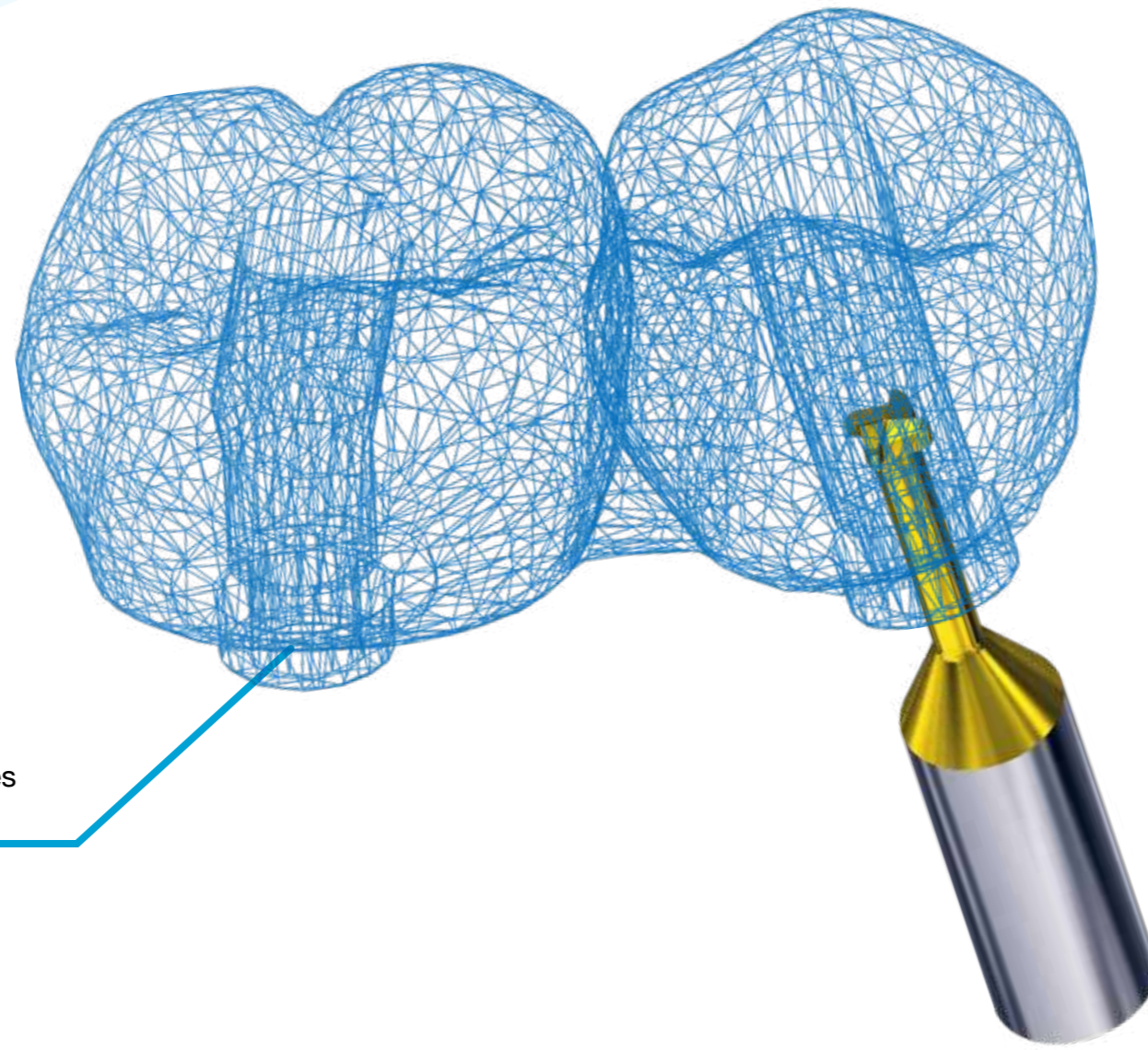

The AURUM Milling Tool replicates the AURUMBase® screw seat.

## The Tool

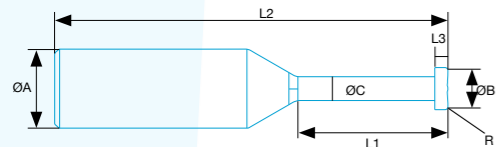

Reference	ØA	ØB	ØC	L1	L2	L3	R
MT3D16L5	3	1,6	0,95	5	51	0,5	0,1
MT4D16L5	4	1,6	0,95	5	51	0,5	0,1
MT6D16L5	6	1,6	0,95	5	51	0,5	0,1

## Integrated in the most popular systems







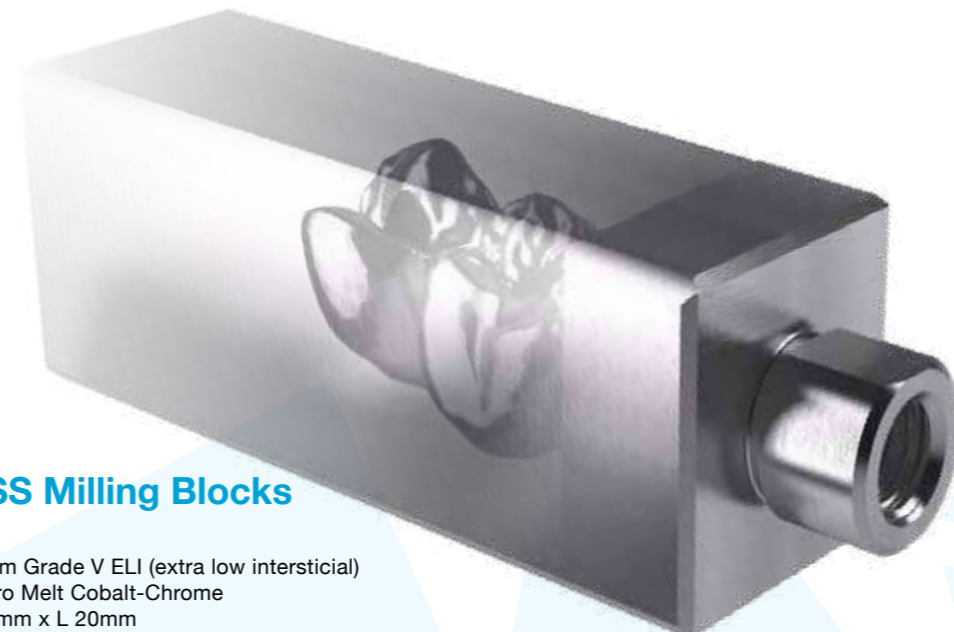















## DESS Milling Blocks

Titanium Grade V ELI (extra low interstitial)  
or Micro Melt Cobalt-Chrome  
∅15mm x L 20mm  
∅15mm x L 40mm



## Connections

-  ACTIVE HEX  
*FITS*  
NOBELACTIVE® & NOBELREPLACE® CC
-  TRI-LOBE  
*FITS*  
NOBELREPLACE SELECT™
-  EXTERNAL HEX UNIVERSAL  
*FITS*  
NOBEL BRÄNEMARK®
-  EXTERNAL HEX USA  
*FITS*  
3i OSSEOTITE®
-  INTERNAL HEX "CLICK"  
*FITS*  
3i CERTAIN®
-  OCTAGON  
*FITS*  
STRAUMANN® SOFT TISSUE LEVEL & synOcta®
-  CONICAL BL  
*FITS*  
STRAUMANN® BONE LEVEL
-  CONICAL BLX  
*FITS*  
STRAUMANN® BLX
-  NEO GM  
*FITS*  
NEODENT® GRAND MORSE
-  INTERNAL HEX USA  
*FITS*  
ZIMMER SCREW-VENT®
-  CONIC EVO  
*FITS*  
ASTRA TECH IMPLANT SYSTEM™ EV
-  INTERNAL HEX CONIC  
*FITS*  
ASTRA TECH OSSEOSPEED™
-  INTERNAL HEX FD  
*FITS*  
DENTSPLY FRIADENT XIVE®
-  CONIC OSS  
*FITS*  
OSSTEM® TS
-  INTERNAL CAM  
*FITS*  
CAMLOG®
-  INTERNAL CON  
*FITS*  
CONELOG®
-  INTERNAL HEX BH  
*FITS*  
BIOHORIZONS® INTERNAL
-  EXTERNAL HEX BH  
*FITS*  
BIOHORIZONS® EXTERNAL
-  INTERNAL HEX MI  
*FITS*  
MIS® SEVEN
-  CONIC ANYR  
*FITS*  
MEGAGEN AnyRidge®
-  CONIC IC  
*FITS*  
MEDENTIS ICX®



# PRE-MILLED BLANK



## NobelActive® NobelReplace® CC Active Hex



			3.0 SILVER 3.0	NP PURPLE 3.5	RP YELLOW 4.3/5.0	WP Blue 5.5
Ti	∅10mm		61.068	61.041	61.042	61.069
	NEW ∅14mm			62.041	62.042	62.069
CoCr	∅14mm		71.068	71.041	71.042	71.069

## NobelReplace Select™ Tri-Lobe



			3.0 PURPLE 3.0	RP YELLOW RP/4.3	WP BLUE WP/5.0	6.0 GREEN 6.0
Ti	∅10mm		61.004	61.005	61.006	61.097
	∅14mm			62.005	62.006	62.097
CoCr	∅14mm		71.004	71.005	71.006	71.097

## NobelBranemark® External Hex Universal



			NP NP/3.5	RP RP/4.1	WP WP/5.1
Ti	∅10mm		61.001	61.002	61.003
CoCr	∅14mm		71.001	71.002	71.003

## 3i Osseotite® External Hex USA



			NP PURPLE 3.4	RP BLUE 4.1	WP Yellow 5.0
Ti	∅10mm		61.011	61.012	61.013
CoCr	∅14mm		71.011	71.012	71.013

## 3i Certain® Internal Hex "CLICK"



			NP PURPLE 3.4	RP BLUE 4.1	WP YELLOW 5.0
Ti	∅10mm		61.014	61.015	61.016
	∅14mm			62.015	62.016
CoCr	∅14mm		71.014	71.015	71.016

## Straumann® Soft Tissue Level & synOcta® Octagon



			NNC NNC 3.5	RN RN 4.1/4.8	WN WN 4.8/6.5
Ti	∅10mm		61.070	61.009	61.045
	NEW ∅14mm			62.009	62.045
CoCr	∅14mm		71.070	71.009	71.045

## Straumann® Bone Level Conical BL



			NP NC/3.3	RP RC/4.1-4.8
Ti	∅10mm		61.043	61.044
	NEW ∅14mm		62.043	62.044
CoCr	∅14mm		71.043	71.044

## Straumann® BLX Conical BLX



			RB PURPLE 3.5	WB BROWN 4.5
Ti	∅10mm		61.062	61.062
	∅14mm			62.063
CoCr	NEW ∅14mm			71.063

**Neodent Grand Morse®**  
NEO GM



Ti	ø10mm		61.035
	ø14mm		62.035
CoCr	ø14mm		71.035

**Zimmer Screw-Vent®**  
Internal Hex USA



Ti	ø10mm		61.017	61.018	61.019
	ø14mm		62.017	62.018	62.019
CoCr	ø14mm		71.017	71.018	71.019

**Astra Tech Implant System™ EV**  
Conic EVO



Ti	ø10mm		61.059	61.060	61.061
	ø14mm		62.059	62.060	62.061
CoCr	ø14mm		71.059	71.060	71.061

**Astra Tech Osseospeed™**  
Internal Hex Conic



Ti	ø10mm		61.023	61.024	61.025
	ø14mm			62.024	62.025
CoCr	ø14mm			71.024	71.025

**Dentsply friadent® XIVE®**  
Internal Hex FD



			NP SILVER 3.4	RP YELLOW 3.8	WP BLUE 4.5	5.5 RED 5.5
Ti	ø10mm		61.038	61.039	61.040	61.071
	ø14mm			62.039	62.040	62.071
CoCr	ø14mm		71.038	71.039	71.040	71.071

**Ankylos® C/X**  
Internal ANK



Ti	ø10mm		61.250
CoCr	ø14mm		71.250

**Osstem® TS**  
Conic OSS



			Mini YELLOW mini	STD GREEN regular
Ti	ø10mm		61.072	61.073
	ø14mm		62.072	62.073
CoCr	ø14mm		71.072	71.073

**Camlog®**  
Internal CAM



			3.3 SILVER 3.3	3.8 YELLOW 3.8	4.3 PINK 4.3	5.0 BLUE 5.0
Ti	ø10mm		61.064	61.065	61.066	61.067
	ø14mm			62.065	62.066	62.067
CoCr	ø14mm		71.064	71.065	71.066	71.067

**Conelog®**  
Internal CON



			NP SILVER 3.3	RP YELLOW 3.8/4.3	WP BLUE 5.0
Ti	∅10mm		61.074	61.075	61.076
	∅14mm		62.074	62.075	62.076
CoCr	∅14mm		71.074	71.075	71.076

**Biohorizons®**  
Internal Hex BH



			3.0 SILVER 3.0	NP YELLOW 3.5	RP GREEN 4.5	WP BLUE 5.7
Ti	∅10mm	61.099		61.087	61.088	61.089
	∅14mm			62.088	62.089	

**Biohorizons®**  
External Hex BH



			NP YELLOW 3.7	RP GREEN 4.2	WP BLUE 5.2
Ti	∅10mm	61.020		61.021	61.022
CoCr	∅14mm			71.021	71.022

**MIS® Seven**  
Internal Hex MI



			NP YELLOW 3.3	SP PURPLE 3.75-4.2	WP GREEN 5.0-6.0
Ti	∅10mm	61.056		61.095	61.096
CoCr	∅14mm			71.095	71.096

**MIS® C1**  
Conic MC



			NP YELLOW	SP PURPLE	WP GREEN
Ti	∅10mm	61.081		61.082	61.083

**MIS® V3**  
Conic MV



			NP BLUE	SP PURPLE
Ti	∅10mm	61.084		61.082

**Megagen AnyRidge®**  
Conic ANYR



Ti	∅10mm	61.057
CoCr	∅14mm	71.057

**Anthogyr Axiom®**  
Conic Axio



Ti	∅10mm	61.077
----	-------	--------

**Medentis ICX®**  
CONIC IC



Ti	∅10mm	61.080
	∅14mm	62.080
CoCr	∅14mm	71.080

**Dentium Superline™ & Implantium®**  
Conic DENT



			YELLOW / RP / GREEN / BLUE / RED 3.6 3.8 4.0 4.5 5.0				
Ti	∅10mm	61.090					
	∅14mm	62.090					
CoCr	∅14mm	71.090					

**Bego Semados®**  
Internal SEM



		3.25/3.75 GREEN/BLUE	4.1 SILVER	4.5 RED	5.5 YELLOW
Ti	∅10mm	61.091	61.092	61.093	61.094
	∅14mm				62.094
CoCr	∅14mm				71.094

**Biotech Kontakt®**  
Conic Bio



Ti	∅10mm	61.078
CoCr	∅14mm	71.078

**Blocks**



Ti	□15mm L 20mm	63.020
	□15mm L 40mm	63.040
CoCr	□15mm L 20mm	73.020
	15mm	73.040

**AURUM Milling Tool**

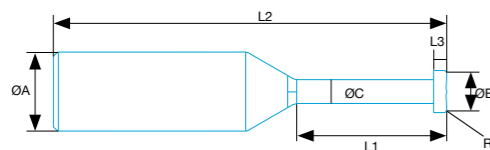

	ØA	ØB	ØC	L1	L2	L3	R
MT3D16L5	3	1,6	0,95	5	51	0,5	0,1
MT4D16L5	4	1,6	0,95	5	51	0,5	0,1
MT6D16L5	6	1,6	0,95	5	51	0,5	0,1

**HOLDERS**



HLDSTD

for standard 98mm disc machines

Any milling machine with a 98 mm disc holder



HLDIMES

for Imes-Icore® machines

Coritec 245i touch  
Coritec 250i touch  
Coritec 350i / Coritec 350i Loader  
Coritec 450i  
Coritec 550i  
Coritec 650i / Coritec 650i Loader



HLDVHF

for VHF®

VHF® S1  
VHF® S2  
VHF® K5



HLDVHFR5

for VHF®

VHF R5



HLDYENA

for Yenadent®

D6  
D15  
D43N



HLDVHFN4

for VHF®

VHF® N4



HLDVHFZ4

for VHF®

VHF® Z4



HLD3R

for machines with support/changer 3R

D14P  
DC40  
D43N

**Adaptors for ZirkonZahn® holders**



HLDZZ

**Adaptadors ZirkonZahn machines**

M1 abutment  
M1 wet heavy metal  
M4 wet heavy metal  
M5 heavy metal  
M6 wet heavy metal



# Quick Reference Guide

## Tool Selector

Brand	Model	Tool Diameter
<b>3M-ESPE</b>	LAVA CVC 240	3mm
<b>AMANN GIRRBACH</b>	CERAMILL MOTION 2 5X, MIKRO 5X, MIKRO 4X, MIKRO IC	3mm
<b>CHARLY DENTAL</b>	CD04-S, CD05-S	3mm
	CD50	3mm / 4mm / 6mm
<b>DATRON</b>	D5	3mm / 4mm / 6mm
	D1	4mm
<b>DENTAL CONCEPT SYSTEMS</b>	DC5, DC1	6mm
<b>DENTASWISS</b>	DS2000, DS2100	3mm
<b>DMG MORI</b>	ULTRASONIC 10, ULTRASONIC 20	3mm / 4mm / 6mm
<b>DT DIGITAL</b>	FINOCAM A5, FINOCAM CA, FI-NOCAM CA+	3mm
<b>ERNST HINRICHS</b>	HINRIMILL 5, HINRIMILL 5.8, HINRIMILL T5	3mm
<b>EUROMAX MONACO</b>	OPERA EASY 5, OPERA EXPERT 5, OPERA PRO-EXPERT 5	3mm
	OPERA PREMIUM	6mm
<b>GOLDQUADRAT</b>	QUATTRO MILL MAXI, QUATTRO MILL COMFORT 5X	3mm
<b>IMES-ICORE</b>	CORITEC ONE, CORITEC 140I, CORITEC 245I, CORITEC 250I	3mm
	CORITEC 350I, CORITEC 450I, CORITEC 650I, CORITEC 750I	6mm
<b>JENSEN</b>	PRECISO M305-X, PRECISO M205 MILL	3mm
<b>MANI SCHÜTZ DENTAL</b>	TIZIAN CUT 5 DRY, TIZIAN CUT ECO PLUS, TIZIAN CUT 5	3mm
	TIZIAN CUT5.2, TIZIAN CUT5.2 PLUS	6mm
<b>MB MASCHINEN</b>	COBRA MILL DESK 5, COBRA MILL 5M, COBRA MILL 48	3mm
	COBRA MILL 5A1	6mm
	COBRA MILL 58	3mm / 4mm / 6mm
<b>R+K ORGANICAL CAD/CAM</b>	ORGANICAL DESKTOP 7C, ORGANICAL DESKTOP 6	3mm
<b>RÖDERS</b>	RXD4, RXD5, RXD5C	3mm / 4mm / 6mm
<b>ROLAND</b>	DWX50, DWX51D	4mm
<b>SHERA</b>	ECO-MILL DRY	3mm
<b>STRAUMANN</b>	CARES M-SERIES	3mm
<b>VHF</b>	S1, S2, K5	3mm
<b>YENADENT</b>	D14, D15, D6, D43, DC40	4mm, 6mm
<b>ZIRKONZAHN</b>	M1 WET HEAVY METAL, M1 ABUTMENT, M4 WET HEAVY METAL, M5 HEAVY METAL, M6 WET HEAVY METAL	6mm

All DESS products are manufactured according to ISO 9001 and ISO 13485 with CE marking for all products Class IIb.

3i® and 3i® Certain® and Osseotite® are registered trademarks of 3i Implant Innovations, USA  
 ASTRA TECH™, OsseoSpeed™, ANKYLOS® C/X, XiVE®, FRIADENT®, ASTRATECH implant system™ EV and UniAbutment® are registered trademarks of DENTSPLY SIRONA Inc.  
 BioHorizons® is a registered trademark of BioHorizons, INC.  
 Megagen® is a registered trademark of Mega'gen Implant Co. Ltd  
 Osstem® is a registered trademark of Osstem Implant Co. Ltd  
 Camlog®, Conelog® are registered trademarks Camlog Biotechnologies GmbH  
 Dentium Superline™ & Implantium® are registered trademarks of Dentium Co. Ltd  
 Brånemark System®, NobelReplace® and Replace Select™, NobelActive™, NobelReplace® CC, NobelSpeedy™ and Multi-unit® are registered trademarks of Nobel Biocare AB, Sweden  
 ITI®, Straumann® and synOcta® are registered trademarks of Straumann Holding AG, Switzerland  
 MIS® is a registered trademark of MIS Implant Technologies Ltd.  
 Zimmer Screw-Vent® and SwissPlus® are registered trademarks of Zimmer Dental INC, USA  
 Yenadent® is a registered trademark of Yenadent Ltd. Sti.  
 ZirkonZahn® is a registered trademark of Zirkonzahn GmbH  
 Imes-icore® is a registered trademark of Imes-icore GmbH

DESS products can be used only by licensed dentists, physicians and labs.

Please refer always to the instructions of use available on the website

[www.dess-abutments.com](http://www.dess-abutments.com)

or supplied with the product.

Some products may not be available in your country.

Please contact your local distributor for more details.



DOC-21-EN-01

